

A-1 Attachment

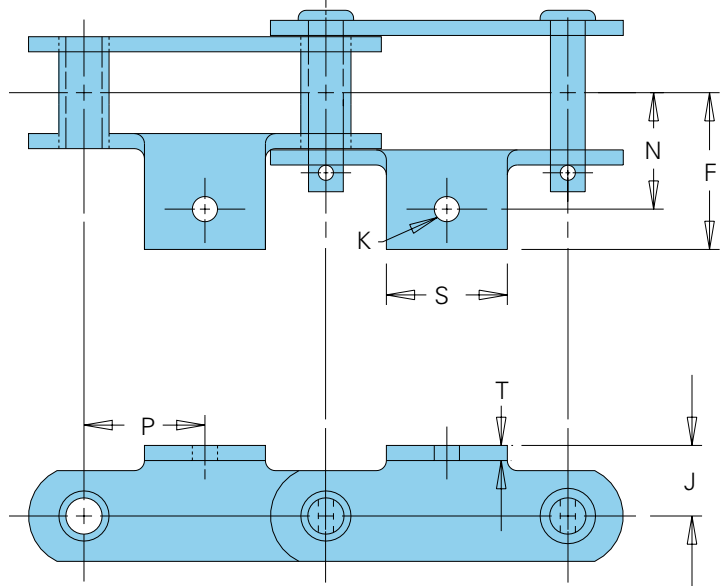

A-2 Attachment

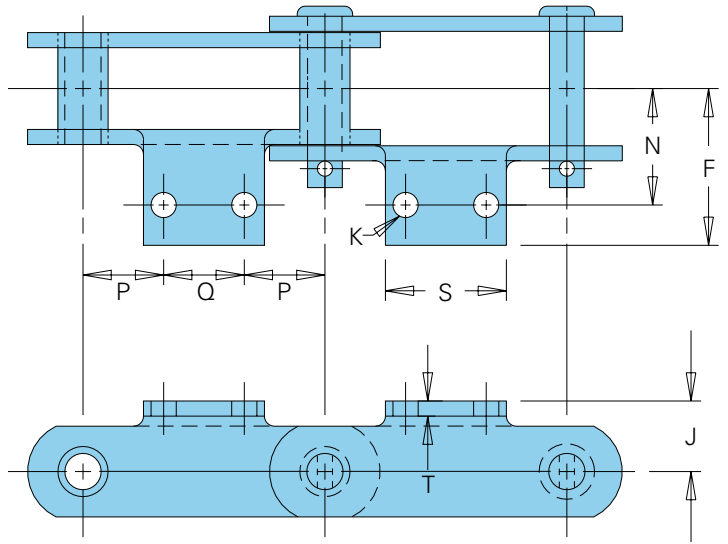

A-22 and A-42 Attachment

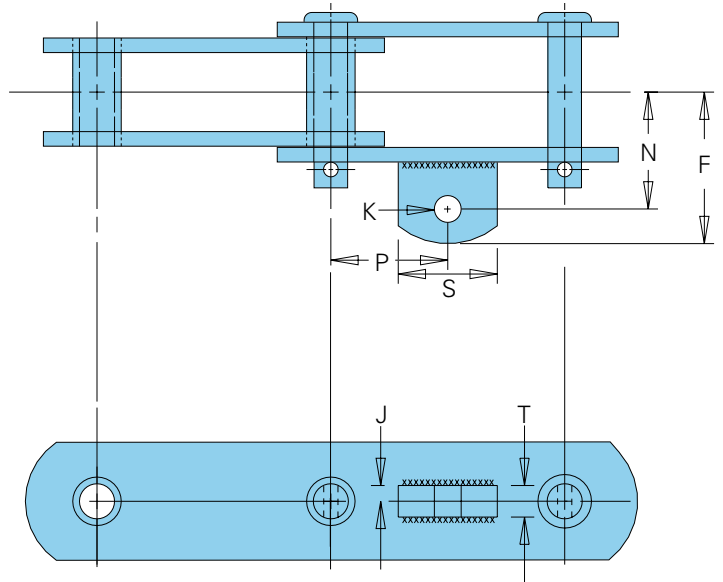

Steel Bushed Attachment Specifications

All dimensions are in inches unless otherwise indicated.

Attach. Number	Chain Number	N	Q	J	S	F	P	Bolt Diameter	K	T	Approx. Weight (lbs./ft.)
A-1	188	1.88		.81	2.13	2.61	1.30	.38		.25	4.8
	131	2.06		1.00	1.31	3.02	1.54	.50		.38	8.9
	102B	2.38		1.00	2.81	3.34	2.00	.38		.38	8.9
	111	3.13		1.50	3.63	3.75	2.38	.50		.38	12.7
	110	2.66		1.00	2.81	3.53	3.00	.38		.38	8.6
A-2	188	2.09	1.25	.81	2.13	2.61	.68	.31		.25	4.8
	131	2.06	1.50	1.13	2.88	2.91	.78	.50		.38	8.9
	102B	2.66	1.75	1.00	2.81	3.34	1.13	.38		.38	8.0
	111	3.13	2.31	1.50	3.63	4.13	1.22	.38		.38	12.4
	110	2.66	1.75	1.00	2.89	3.32	2.13	.38		.38	7.5
A-22 & A-42	188	1.78		.19	1.25	2.38	1.19	.38		.38	4.8
	131	2.63		.16	1.25	3.50	1.53	.38		.38	8.4
	102B	3.13	1.75	.16	1.25	3.88	2.00	.38		.31	7.8
	111	3.38		.19	1.25	4.13	2.38	.50		.38	10.8
	110	3.13		.19	2.00	4.13	3.00	.50		.38	7.1

To locate compatible sprockets for your chain, refer to the Product Cross-Reference in Section D.

Note: Dimensions are subject to change. Contact Union Chain to obtain certified prints for design and construction.



UNION CHAIN DIVISION - STEEL BUSHED CHAINS

U.S. TSUBAKI

A - ENGINEERING CLASS CHAINS

K-1 Attachment

K-2 and K-22 Attachment

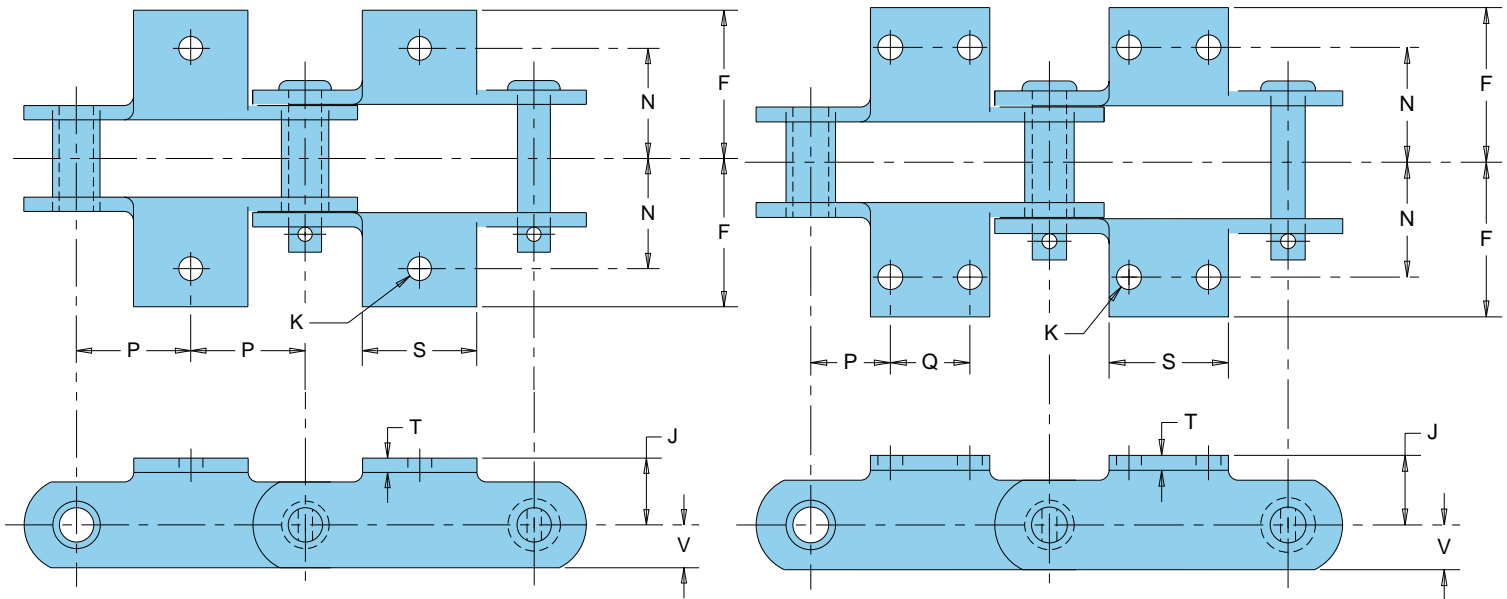

Steel Bushed Attachment Specifications (Continued)

All dimensions are in inches unless otherwise indicated.

Attach. Number	Chain Number	N	M	R	F	L	Q	S	P	Bolt Dia.	K	J	T	V	Approx. Weight (lbs./ft.)
K-1	188	1.88			2.61			2.13	1.30	.38	.81	.25	.56	5.8	
	131	2.06			3.02			1.31	1.54	.50	1.00	.38	.75	10.2	
	102B	2.38			3.34			2.81	2.00	.38	1.00	.38	.75	9.0	
	111	3.13			3.75			3.63	2.38	.50	1.50	.38	1.00	15.2	
K-2	188	2.09			2.61		1.25	2.13	.68	.31	.81	.25	.56	5.8	
	131	2.06			2.91		1.50	2.88	.78	.50	1.13	.38	.75	10.2	
	102B	2.66			3.34		1.75	2.81	1.13	.38	1.00	.38	.75	9.0	
	110	2.66			3.32		1.75	2.88	2.13	.38	1.00	.38	.75	8.6	
	111	3.13			4.13		2.31	3.63	1.22	.50	1.50	.38	1.00	15.2	
	111SP	3.13			4.13		2.31	3.63	1.22	.50	1.50	.38	1.00	15.2	
	150X	3.75			4.91		2.75	4.25	1.66	.50	1.88	.50	1.25	23.0	
4856	3.31			4.41		2.25	4.25	1.88	.50	1.88	.50	1.25	23.0		
K-22	102-1/2	2.66			3.27		1.75	3.13	1.16	.50	1.13	.38	.88	24.0	
	111	3.13			4.13		2.31	3.63	1.23	.38	1.50	.38	1.00	15.2	
	4856	3.16			4.25		2.25	4.25	1.88	.63	1.88	.50	1.25	23.0	

■ Indicates this chain is normally stocked. All others are made-to-order.

To locate compatible sprockets for your chain, refer to the Product Cross-Reference in Section D.

Note: Dimensions are subject to change. Contact Union Chain to obtain certified prints for design and construction.

K-24 Attachment

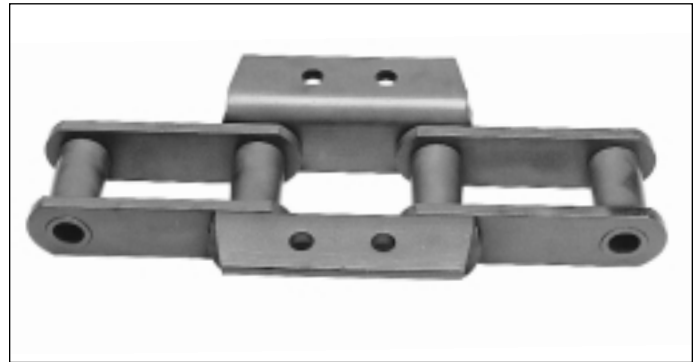
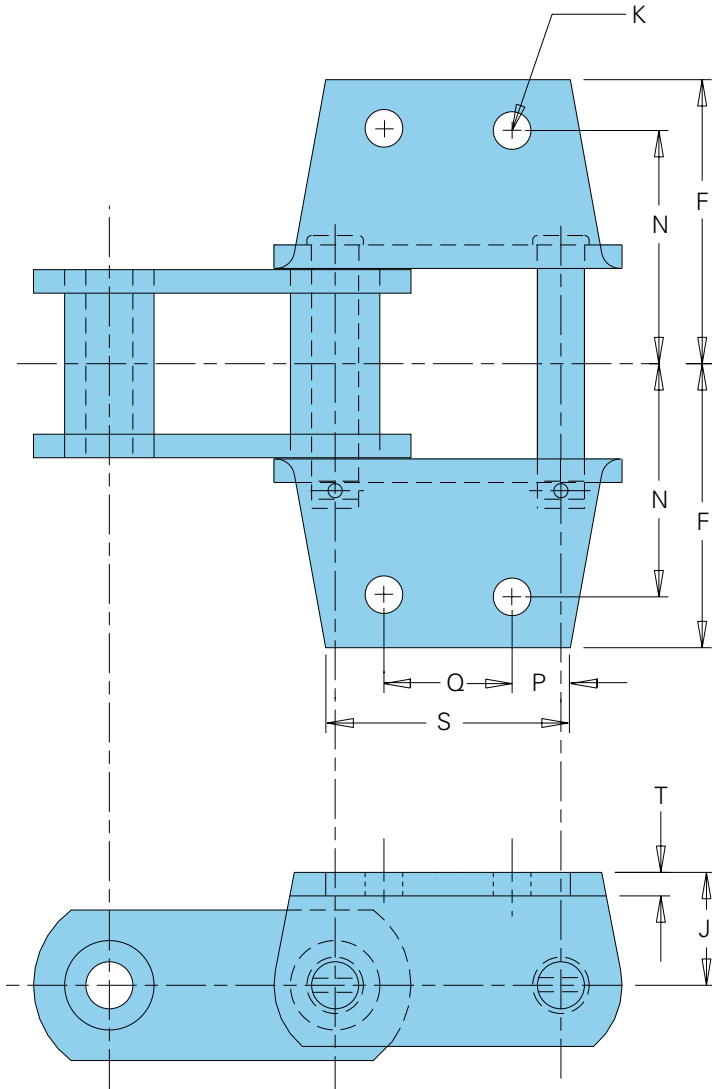

Steel Bushed Attachment Specifications (Continued)

All dimensions are in inches unless otherwise indicated.

Attach. Number	Chain Number	N	M	R	F	L	Q	S	P	Bolt Dia. K	J	T	V	Approx. Weight (lbs./ft.)
K-24	4856	3.63			4.75		2.50	7.25	1.75	.63	1.88	.50		27.5

Indicates this chain is normally stocked. All others are made-to-order.

To locate compatible sprockets for your chain, refer to the Product Cross-Reference in Section D.

Note: Dimensions are subject to change. Contact Union Chain to obtain certified prints for design and construction.

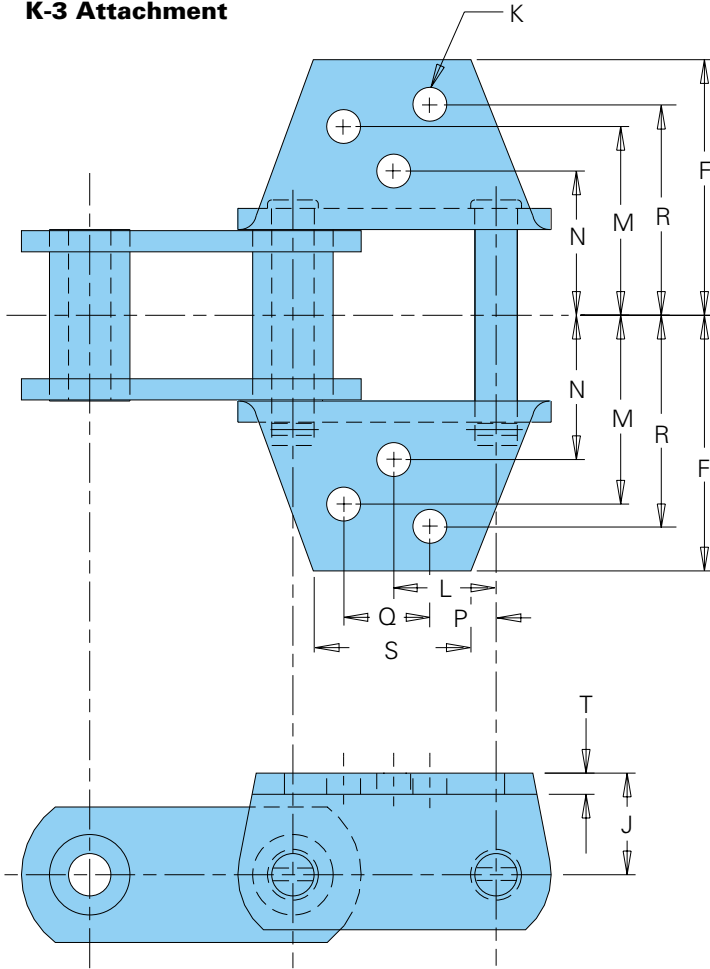
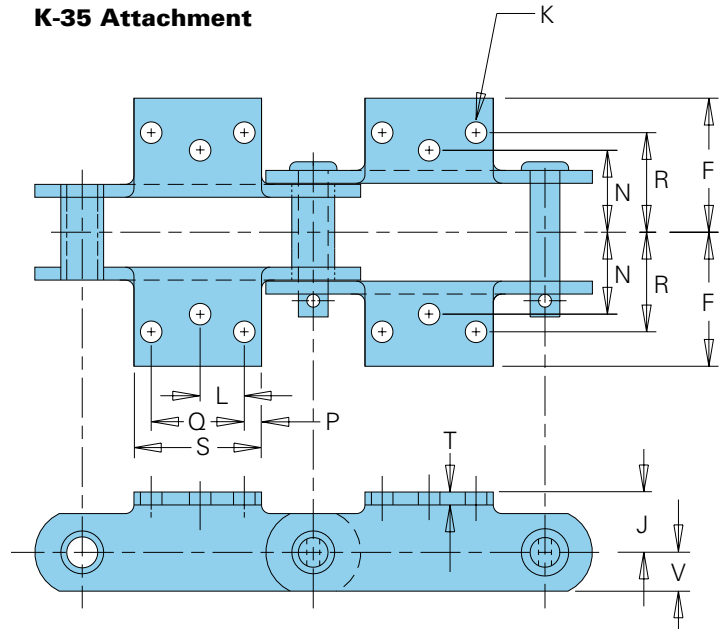
K-3 Attachment

K-35 Attachment

Steel Bushed Attachment Specifications (Continued)

All dimensions are in inches unless otherwise indicated.

Attach. Number	Chain Number	N	M	R	F	L	Q	S	P	Bolt Dia.	K	J	T	V	Approx. Weight (lbs./ft.)
K-3	150X	3.75		5.75	6.53	3.02	2.75	4.25	1.66	.50	1.88	.50			26.9
	4856	3.28	5.47	6.03	6.75	3.00	2.75	4.25	1.63	.50	1.88	.50			27.5
K-35	4856	3.63		6.13	6.75	1.25	2.50	6.44	1.75	.63	1.88	.50	1.25		27.5

To locate compatible sprockets for your chain, refer to the Product Cross-Reference in Section D.

Note: Dimensions are subject to change. Contact Union Chain to obtain certified prints for design and construction.

K-44 and K-443 Attachment

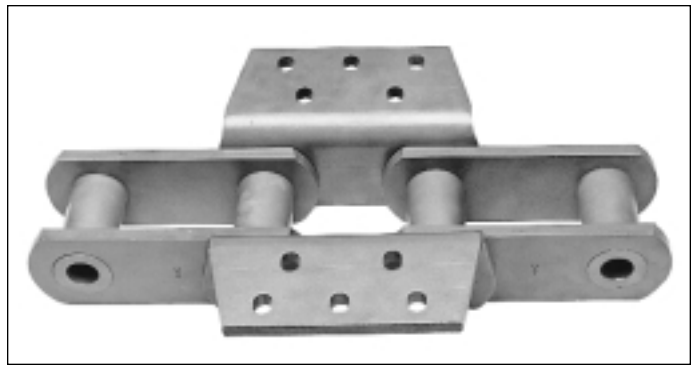
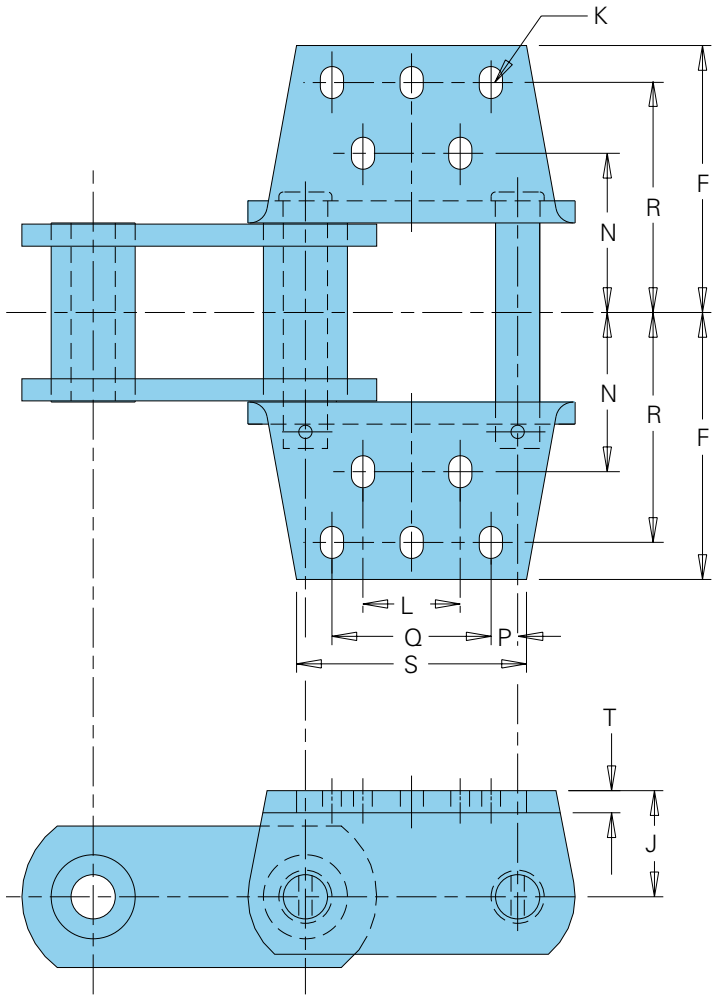

Steel Bushed Attachment Specifications (Continued)

All dimensions are in inches unless otherwise indicated.

Attach. Number	Chain Number	N	M	R	F	L	Q	S	P	Bolt Dia.	K	J	T	V	Approx. Weight (lbs./ft.)
K-44	4857	3.50		6.00	7.25	3.50	3.50	6.56	1.25	.50	2.50	.50			42.0
	4859	4.50		6.50	7.55	2.75	4.50	6.50	.75	.63	3.00	.63			67.0
K-443	4864	4.50		6.50	7.55	3.75	5.50	8.56	.75	.63	3.00	.63			53.0

Indicates this chain is normally stocked. All others are made-to-order.

To locate compatible sprockets for your chain, refer to the Product Cross-Reference in Section D.

Note: Dimensions are subject to change. Contact Union Chain to obtain certified prints for design and construction.