

U.S. TSUBAKI LAMBDA® CHAINS



LAMBDA for lube-free drive applications

- Operates in temperatures up to 302°F
- Same maximum allowable load as our standard RS chain
- Available in sizes from RSD40 to RSD140

Single Strand Drive LAMBDA®

U.S. TSUBAKI Chain No.	Standard Type of Pin*	Pitch P	Roller Dia. R	Width Between Roller Link Plates W**	Link Plates				Pin				Average Tensile Strength lbs.	Maximum Allowable Load lbs.	Approx. Weight lbs./ft.
					PLP Thickness T ₁	RLP Thickness T ₂	RLP Height H	PLP Height h	D	L ₁	L ₂	L			
RSD40-LAMBDA	R	.500	.312	.297	.060	.080	.472	.409	.156	.344	.411	.787	4,300	816	0.47
RSD50-LAMBDA	R	.625	.400	.365	.080	.094	.591	.512	.200	.423	.490	.945	7,050	1,430	0.75
RSD60-LAMBDA	R	.750	.469	.483	.094	.125	.713	.614	.234	.541	.616	1.260	9,920	1,980	1.16
RSD80-LAMBDA	R	1.000	.625	.609	.125	.156	.949	.819	.312	.675	.797	1.571	17,600	3,310	1.86
RSD100-LAMBDA	C/R	1.250	.750	.736	.156	.187	1.185	1.024	.375	.813	.939	1.870	26,500	5,070	2.89
RSD120-LAMBDA	C/R	1.500	.875	.974	.187	.220	1.425	1.228	.437	1.014	1.179	2.323	37,500	6,830	4.30
RSD140-LAMBDA	C/R	1.750	1.000	.974	.220	.252	1.661	1.433	.500	1.091	1.268	2.508	48,500	9,040	5.40

Double Strand Drive LAMBDA®

U.S. TSUBAKI Chain No.	Standard Type of Pin*	Pitch P	Roller Dia. R	Width Between Roller Link Plates W**	Link Plates				Pin				Average Tensile Strength lbs.	Maximum Allowable Load lbs.	Approx. Weight lbs./ft.
					PLP Thickness T ₁	RLP Thickness T ₂	RLP Height H	PLP Height h	D	L ₁	L ₂	C			
RSD40(H)-2LAMBDA	R	.500	.312	.297	.080	.080	.472	.409	.156	.689	.754	.646	8,600	1,390	1.00
RSD50(H)-2LAMBDA	R	.625	.400	.365	.094	.094	.591	.512	.200	.825	.892	.776	14,100	2,430	1.64
RSD60(H)-2LAMBDA	R	.750	.469	.483	.125	.125	.713	.614	.234	1.083	1.181	1.028	19,840	3,370	2.41
RSD80(H)-2LAMBDA	R	1.000	.625	.609	.156	.156	.949	.819	.312	1.358	1.492	1.283	35,200	5,630	4.15
RSD100(H)-2LAMBDA	C	1.250	.750	.736	.187	.187	1.185	1.024	.375	1.630	1.736	1.539	53,000	8,620	6.07
RSD120(H)-2LAMBDA	C	1.500	.875	.974	.220	.220	1.425	1.228	.437	2.014	2.171	1.924	75,000	11,600	8.67
RSD140(H)-2LAMBDA	C	1.750	1.000	.974	.252	.252	1.661	1.433	.500	2.163	2.343	2.055	97,000	15,400	11.01

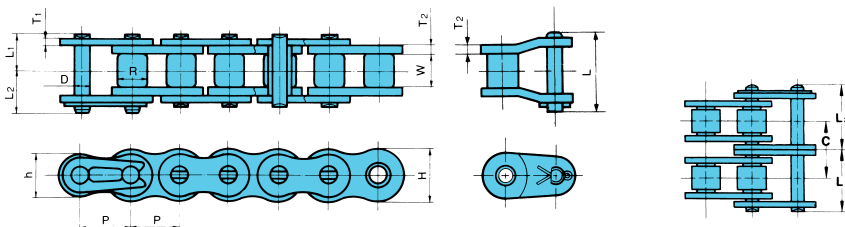

* R indicates riveted, C indicates cottered, C/R indicates available with cottered or riveted pins.

** Width between roller link plates (W) is slightly narrower than ANSI standard, however this chain runs on standard sprockets.

Note:

1. Drive and Conveyor series LAMBDA chains cannot be intercoupled or interchanged.
2. The heavy roller link plates slightly increase the width, which means Drive LAMBDA connecting links are required.
3. Connecting links for RSD80-LAMBDA to RSD140-LAMBDA and RSD80(H)-2LAMBDA to RSD140(H)-2LAMBDA have cottered pins.
4. Double Strand Drive LAMBDA requires heavy-series sprockets.