

ATC Chain Options

Tool Pot (for SK, SK-W, HP types)

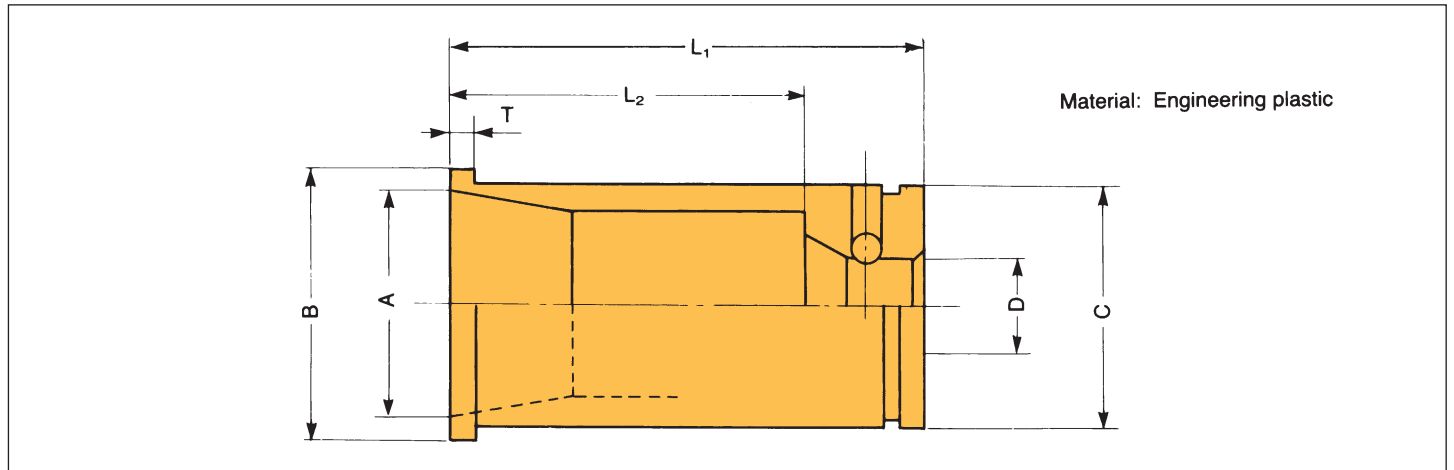

U.S. TSUBAKI Shank No.	Retention Knob	A	B	C	D	L ₁	L ₂	T	Weight lbs.	Extracting Force lbs.
40	MAS	1.750	2.559	2.165	0.614	4.016	2.717	0.394	0.6	33-55
	ISO, ANSI, CAT				0.768		2.835			
50	MAS	2.750	3.307	3.071	0.929	6.102	4.488	0.252	1.5	55-77
	ISO, ANSI, CAT				1.165		4.252		1.8	

Note: If the extracting force required exceeds those listed, consult U.S. Tsubaki. Shanks No. 45 and 60 are available.

Key (for all types)

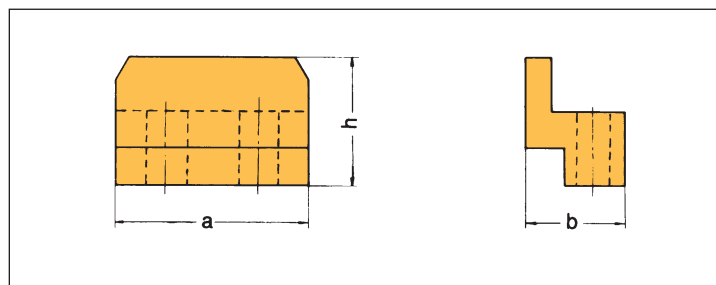

Shank No.	a	b	h
40	0.606	0.472	0.520
50	0.965	0.520	0.669

Note: Shanks No. 45 and 60 are available.

Shank No.	e	f
40	1.968	0.591
50	2.205	0.787

MATERIAL: ALUMINUM

Note: Shanks No. 45 and 60 are the same size as shank No. 50.

Number plate (for all types)

