

U.S. TSUBAKI STANDARD ATTACHMENT CHAIN

Double Pitch Attachment Chain

DOUBLE PITCH ROLLER CHAIN ATTACHMENTS

U.S. Tsubaki Double Pitch conveyor chains are available with standard bent or straight type attachments on one or both sides. Extended pin attachments are also available from our Service Centers. Many assembled chains and components are stocked for quick delivery.

B - CONVEYOR CHAINS

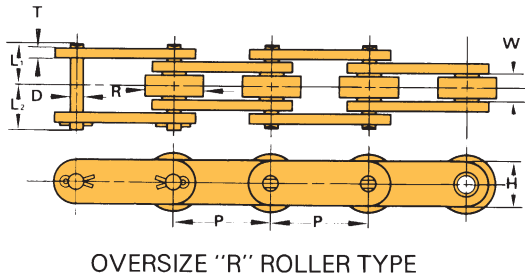
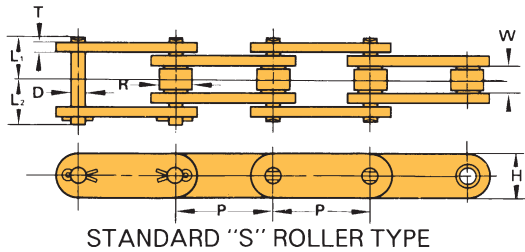

A-1 Attachment



K-2 Attachment



SA-1 Attachment



SK-2 Attachment



D-3 Attachment



GK-1 Attachment

U.S. TSUBAKI Chain No.	Pitch P	Roller Diameter R	Width Between Roller Link Plates W	Pin			Link Plate		Average Tensile Strength lbs.	Max. Allowable Load lbs.	Approx. Weight lbs. / ft.	Additional Weight per Attachment lbs./att.		
				D	L ₁	L ₂	T	H				A & SA Att.	K & SK Att.	D-1 Att.
STANDARD ROLLER TYPE														
C2040	1.000	.312	.312	.156	.325	.392	.060	.472	3,750	595	.34	.007	.013	.002
C2050	1.250	.400	.375	.200	.406	.472	.080	.591	6,170	970	.56	.013	.026	.004
C2060H	1.500	.469	.500	.234	.573	.652	.125	.677	9,040	1,410	1.01	.037	.075	.007
C2080H	2.000	.625	.625	.312	.720	.823	.156	.906	15,400	2,400	1.62	.071	.141	.015
C2100H	2.500	.750	.750	.375	.830	.980	.187	1.15	24,300	3,840	2.38	.132	.265	.026
C2120H	3.000	.875	1.000	.437	1.030	1.210	.219	1.37	34,000	5,380	3.41	.221	.441	—
C2160H	4.000	1.125	1.250	.563	1.337	1.514	.281	1.87	58,000	9,190	6.02	.448	.895	—
OVERSIZE ROLLER TYPE														
C2042	1.000	.625	.312	.156	.325	.392	.060	.472	3,750	595	.58	.007	.013	.002
C2052	1.250	.750	.375	.200	.406	.472	.080	.591	6,170	970	.87	.013	.026	.004
C2062H	1.500	.875	.500	.234	.573	.652	.125	.677	9,040	1,410	1.47	.037	.075	.007
C2082H	2.000	1.125	.625	.312	.720	.823	.156	.906	15,400	2,400	2.37	.071	.142	.015
C2102H	2.500	1.562	.750	.375	.830	.980	.187	1.15	24,300	3,840	3.90	.132	.265	.026
C2122H	3.000	1.750	1.000	.437	1.030	1.210	.219	1.37	34,000	5,380	5.46	.221	.441	—
C2162H	4.000	2.250	1.250	.563	1.337	1.514	.281	1.87	58,000	9,190	9.21	.448	.895	—

Note: 1. Heavy side plates are used for C2060H, C2062H and up.

2. Spring clip type connecting links will be provided for C2040 ~ C2060H and C2042 ~ C2062H, unless otherwise specified.

■ Attachments

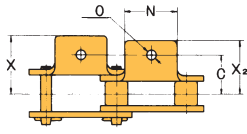

A-1 Attachment

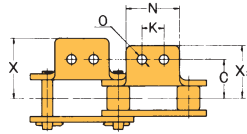

A-2 Attachment

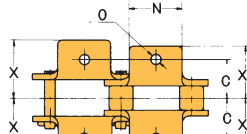

K-1 Attachment

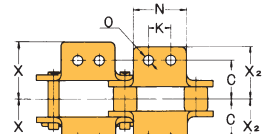

K-2 Attachment

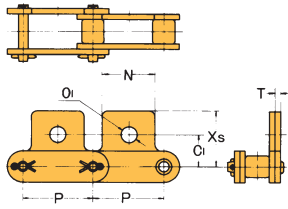

SA-1 Attachment

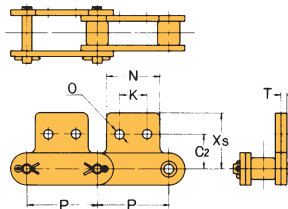

SA-2 Attachment

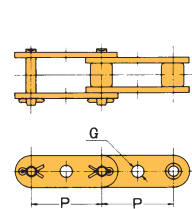

GK-1 Attachment
(except oversize roller type)

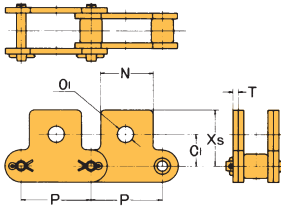

SK-1 Attachment

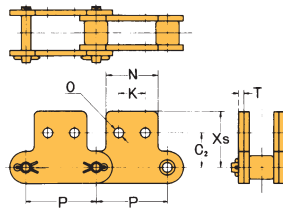

SK-2 Attachment

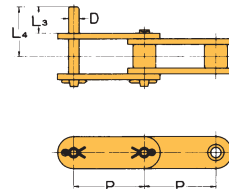

D-1 Attachment

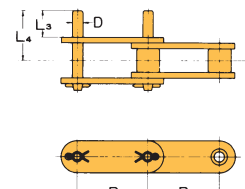

D-3 Attachment

U.S. TSUBAKI	A-1, A-2, K-1 and K-2 Attachments								SA-1, SA-2, SK-1 and SK-2 Attachments							D and GK-1 Attachments				
	Chain No.	X	X ₂	C	S	K	N	O	X _s	C ₁	C ₂	K	N	O	O ₁	T	D	L ₃	L ₄	G
C2040	.760	.693	.500	.358	.374	.752	.142	.780	.437	.535	.374	.752	.142	.205	.060	.156	.374	.663	.161	
C2050	.953	.866	.626	.437	.469	.937	.205	.969	.563	.626	.469	.937	.205	.268	.080	.200	.469	.833	.201	
C2060H	1.240	1.110	.844	.579	.563	1.126	.205	1.205	.689	.752	.563	1.126	.205	.343	.125	.234	.563	1.083	.240	
C2080H	1.602	1.441	1.094	.752	.752	1.500	.268	1.594	.874	1.000	.752	1.500	.268	.406	.156	.312	.752	1.401	.319	
C2100H	1.950	1.760	1.312	.922	.937	1.875	.323	1.984	1.125	1.250	.938	1.875	.323	.516	.187	.375	.937	1.687	—	
C2120H	2.390	2.110	1.562	1.093	1.125	2.250	.386	2.361	1.312	1.468	1.125	2.250	.386	.578	.219	.437	1.125	2.062	—	
C2160H	3.060	2.760	2.062	1.437	1.500	3.000	.516	3.093	1.750	2.000	1.500	3.000	.516	.771	.281	.562	1.500	2.718	—	

- Note: 1. Attachments for standard roller type chain and for oversize roller type chain have the same dimensions except for G.
 2. Attachments can be spaced as desired upon request.
 For even number of spacing, attachments will be fitted on pin link unless otherwise specified.
 3. Spring clip type connecting links will be provided for C2040 ~ C2060H and C2042 ~ C2062H.
 4. Dimensions O, O₁ and G show actual hole diameter.