

DOUBLE PLUS® Guide Rails

Aluminum Guide Rail Dimensional Data
Standard and Steel Rail Inserts (For DOUBLE PLUS “VR,” “VRP,” “VR-SC,” & “VRP-SC”)

Guide Rail No.	A	B	C	D	E	F	G	H ₁	H ₂	I	J	K	L	M	N	O	Standard Length ft.	Approx. Weight lbs./ft.
C2030VRP-R3L	1.38	2.36	0.807	1.494	—	0.55	1.268	0.350	0.366	0.390	0.413	0.256	0.197	0.256	0.413	0.197	9.84	0.94
C2030VRP-R3LS	1.38	2.36	0.807	1.494	—	0.55	1.268	0.350	0.366	0.390	0.413	0.256	0.197	0.256	0.413	0.197	9.84	1.48
C2040VRP-R4L	2.48	2.60	1.752	1.388	0.728	0.51	1.374	0.449	0.472	0.531	0.531	0.335	0.295	0.256	0.413	0.197	13.12	1.75
C2040VRP-R4LS	2.48	2.60	1.752	1.388	0.728	0.51	1.374	0.449	0.472	0.531	0.531	0.335	0.295	0.256	0.413	0.197	13.12	2.49
C2050VRP-R4L	3.07	3.15	2.185	1.644	0.906	0.59	1.693	0.56	0.59	0.65	0.689	0.413	0.35	0.335	0.531	0.295	13.12	2.42
C2050VRP-R4LS	3.07	3.15	2.185	1.644	0.906	0.59	1.693	0.56	0.59	0.65	0.689	0.413	0.35	0.335	0.531	0.295	13.12	3.36
C2050VRP-R3H	3.15	5.51	2.26	4.01	0.906	0.59	4.06	0.56	0.59	0.65	0.689	0.413	0.35	0.335	0.531	0.295	9.84	3.36
C2050VRP-R3HS	3.15	5.51	2.26	4.01	0.906	0.59	4.06	0.56	0.59	0.65	0.689	0.413	0.35	0.335	0.531	0.295	9.84	4.23
C2060VRP-R4L	3.74	3.58	2.854	2.018	0.925	0.59	1.988	0.677	0.709	0.768	0.689	0.413	0.354	0.335	0.531	0.295	13.12	2.82
C2060VRP-R4LS	3.74	3.58	2.854	2.018	0.925	0.59	1.988	0.677	0.709	0.768	0.689	0.413	0.354	0.335	0.531	0.295	13.12	3.96
C2060VRP-R4K	3.74	3.58	2.854	1.821	0.925	0.59	1.988	0.677	0.709	0.768	0.689	0.413	0.354	0.335	0.531	0.295	13.12	2.69
C2080VRP-R3LS	3.94	4.92	2.76	3.15	0.47	0.94	2.68	0.91	0.91	0.98	0.689	0.413	0.35	0.335	0.531	0.295	9.84	6.65

Note: The steel rail is fixed to the frame with bolts.

C2030VRP-R3L

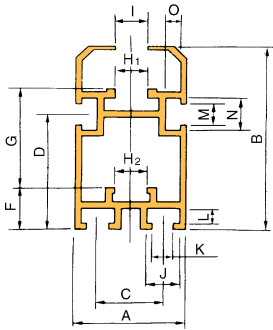

C2040VRP-R4L
C2050VRP-R4L
C2060VRP-R4L

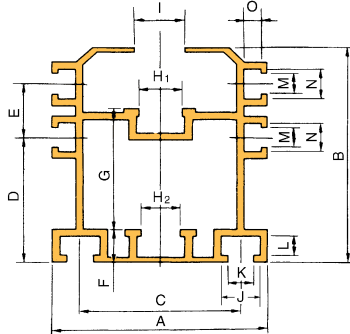

C2050VRP-R3H

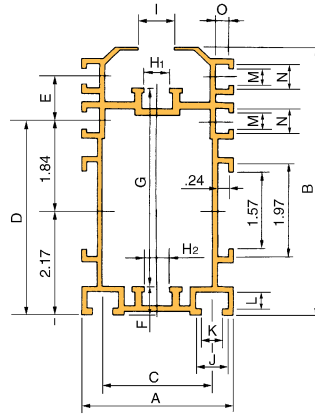

C2060VRP-R4K

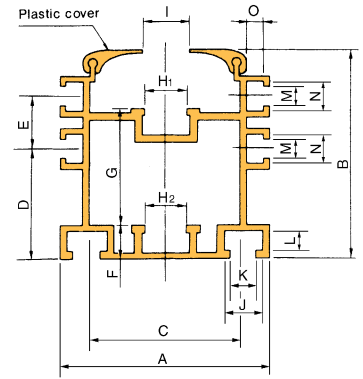

C2030VRP-R3LS

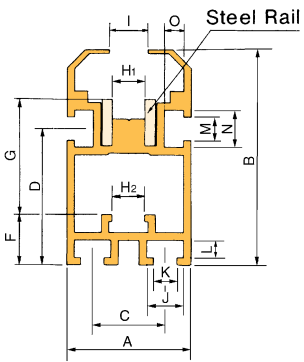

C2040VRP-R3LS
C2050VRP-R3LS
C2060VRP-R3LS

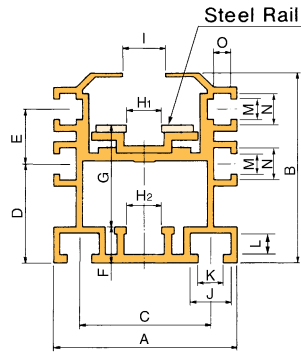

C2050VRP-R3HS

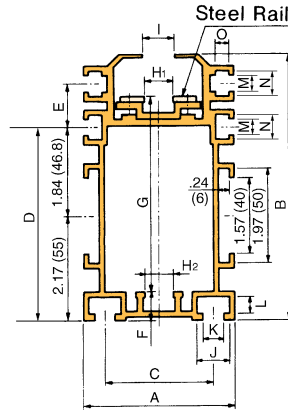

C2080VRP-R3LS

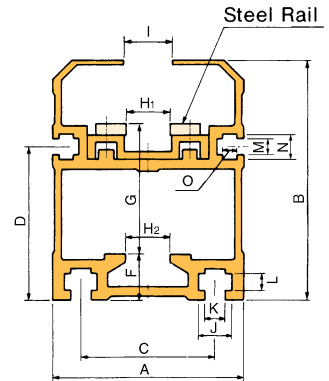

U.S. TSUBAKI FREE FLOW CHAIN

DOUBLE PLUS® ACCESSORIES

Pallet Guide Rails

C2030VRP-PGR

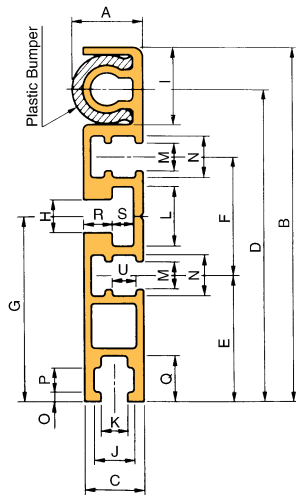

C2040VRP-PGR

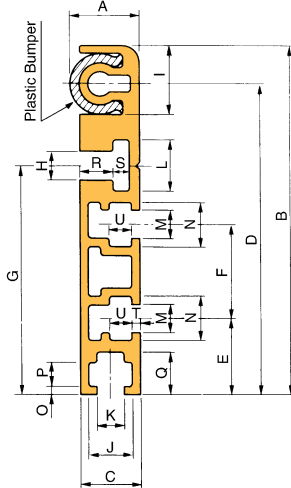

C2050VRP-PGR

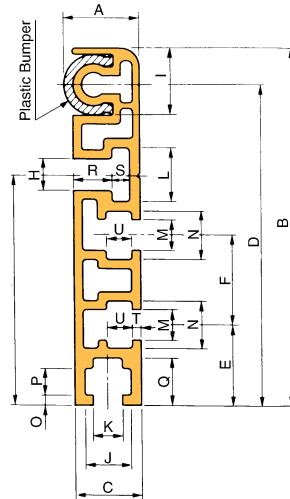

C2060VRP-PGR

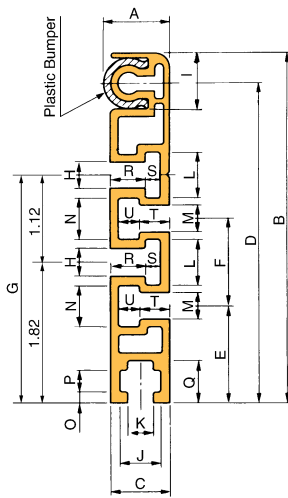

C2080VRP-PGR

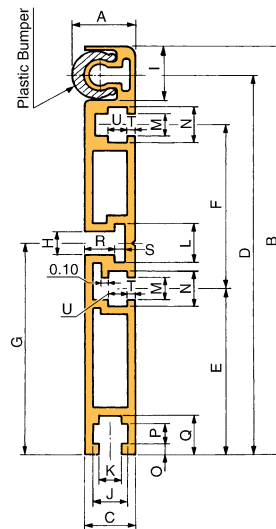

Pallet Guide Rail Dimensional Data

Guide Rail No.	A	B	C	D	E	F	G	H	I	J	K	L	M	N	O	P	Q	R	S	T	U	Standard Length ft.	Approx. Weight lbs./ft.
C2030VRP-PGR	0.60	2.89	0.49	2.51	1.02	0.94	1.50	0.28	0.70	0.33	0.22	0.47	0.22	0.33	0.08	0.20	0.37	0.18	0.24	—	0.20	9.84	0.6
C2040VRP-PGR	0.68	3.27	0.57	2.88	0.71	0.87	2.12	0.28	0.71	0.41	0.26	0.47	0.26	0.41	0.08	0.22	0.39	0.26	0.22	0.08	0.22	13.12	1.0
C2050VRP-PGR	0.88	3.94	0.77	3.50	0.91	0.98	2.55	0.35	0.81	0.53	0.33	0.59	0.33	0.53	0.12	0.30	0.53	0.45	0.20	0.10	0.30	13.12	1.5
C2060VRP-PGR	0.88	4.57	0.77	4.13	1.26	1.12	2.94	0.35	0.81	0.53	0.33	0.59	0.33	0.53	0.14	0.30	0.55	0.45	0.20	0.39	0.28	13.12	1.7
C2080VRP-PGR	0.88	6.10	0.77	5.67	2.46	2.46	3.15	0.35	0.81	0.53	0.33	0.59	0.33	0.53	0.16	0.30	0.57	0.45	0.16	0.12	0.30	9.84	2.4

B - CONVEYOR CHAINS

Plastic Return Guides and Brackets

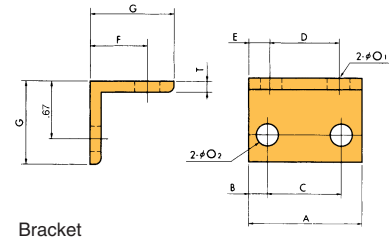
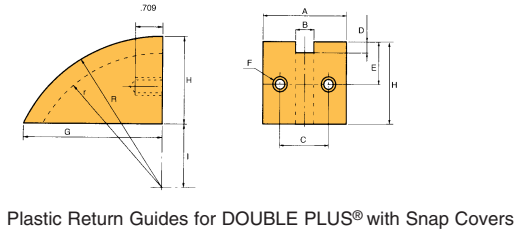
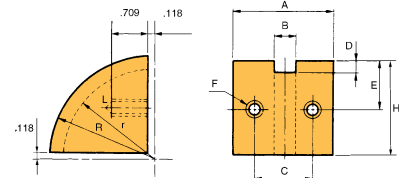
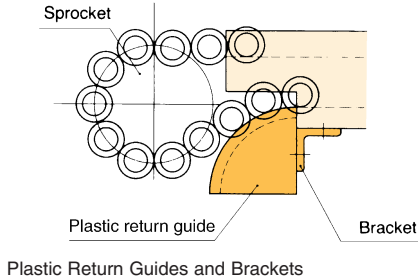

Plastic Return Guide Dimensional Data

Guide No.	A	B	C	D	E	F	G	H	I	r	R
C2030VRP-RG	1.34	0.35	0.87	0.24	1.22	M6	—	2.24	—	2.13	2.36
C2040VRP-RG	1.97	0.47	1.18	0.31	1.18	M8	—	2.24	—	2.05	2.36
C2050VRP-RG	2.20	0.59	1.38	0.39	1.26	M8	—	2.24	—	1.97	2.36
C2050VRP-RG-SC	2.20	0.59	1.38	0.39	1.26	M8	3.56	2.24	1.69	3.54	3.94
C2060VRP-RG	2.36	0.71	1.54	0.49	1.26	M8	—	2.24	—	1.87	2.36
C2060VRP-RG-SC	2.36	0.71	1.54	0.49	1.26	M8	3.56	2.24	1.69	3.44	3.94
C2080VRP-RG	2.76	0.91	1.77	0.59	1.61	M8	—	3.03	—	2.56	3.15
C2080VRP-RG-SC	2.76	0.91	1.77	0.59	1.61	M8	5.50	3.03	3.46	5.91	6.50

Note: Specify SC type for use with Snap Cover DOUBLE PLUS®.
For chain sizes C2030VRP-SC and C2040VRP-SC, use standard plastic return guide.

Bracket Dimensional Data

Chain No.	A	B	C	D	E	F	G	O ₁	O ₂	T	Mounting Bolt Size
C2030VRP-GB	1.34	0.236	0.87	0.807	0.26	0.71	0.98	0.256	0.256	0.12	M6 X 20 ℓ
C2040VRP-GB	2.36	0.591	1.18	1.752	0.30	0.79	1.18	0.335	0.335	0.12	M8 X 20 ℓ
C2050VRP-GB	2.99	0.807	1.38	2.185	0.40	0.94	1.38	0.413	0.335	0.16	M8 X 20 ℓ
C2060VRP-GB	3.70	1.083	1.54	2.854	0.42	0.94	1.38	0.413	0.335	0.16	M8 X 20 ℓ
C2080VRP-GB	3.94	1.083	1.77	2.756	0.59	0.94	1.38	0.413	0.335	0.16	M8 X 20 ℓ