

# U.S. TSUBAKI ATC CHAIN

## HP-T Type

### ATC CHAIN HP-T TYPE WITH TOOL HOLDER

HP-T type ATC chain is based on the HP type with steel tool holder. The inner diameter of the pin is tapered and a retaining function is installed on the pin.

**Economical:** Additional installation of the tool holder is not necessary.

**Accurate holding:** As the tool holder is combined with the chain, backlash is reduced.

**Compactness:** Pin outer diameter and link plate width are smaller than those of HP type.

- 1) U.S. Tsubaki standardized ATC chain is designed with pull stud, key, number plate and plastic sleeve. An engineering plastic sleeve is fitted to prevent contact with the metal taper parts and protect the shank from being scratched.
- 2) Attachment chains other than the listed ATC chain line-up are also available to satisfy your special requirements.

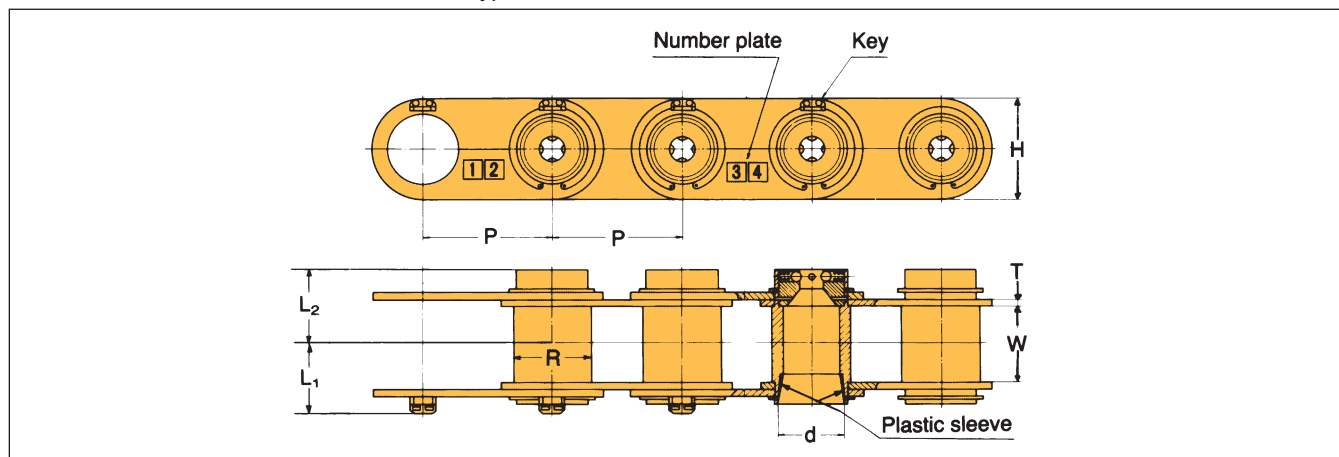

U.S. TSUBAKI Chain Type	Shank No.	P	R	W	T	H	d	L <sub>1</sub>		L <sub>2</sub>		Chain Weight lbs./pot	Extracting Force lbs.	
								MAS	ISO (A)	MAS	ISO (A)			
HP-T	40	3.543	2.362	2.362	0.157	3.288	1.750	1.722	1.693	1.693	2.073	2.244	1.811	4.20
		3.937												4.40
	50	5.118	3.228	3.228	0.248	4.252	2.750	2.427	2.421	2.569	3.242	3.051	2.628	8.40
		5.512												8.60
		6.299												9.00

- Note:
1. If the extracting force required is large, please consult U.S. Tsubaki.
  2. Chain weight less pot shows for MAS standard.
  3. Chain pitches different from those above are also available.
  4. The minimum chain pitch that can be manufactured is:  
Shank No. 40: P = 3.543 inch  
Shank No. 50: P = 4.921 inch
  5. Refer to page B-89 for key and number plate dimensions.
  6. Shanks No. 45 and 60 are also available upon request.

#### Safety device for HP-T type chain (optional)

In the case of horizontal drive HP-T type chain (with tools vertically suspended), we can provide the tool holder with an optional safety device.

The safety device prevents the tool from falling out of the tool holder during operation.

Note:  
The safety device is not available for Shank No. 40. Instead, we suggest using a higher tool extraction force.

Pushing the safety device pin by the cylinder easily releases the tool from the retention knob by spring force.

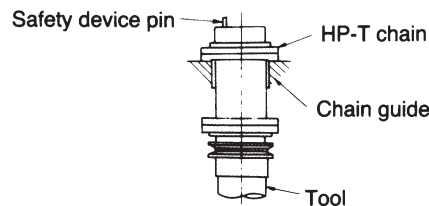

# HP Type

Hollow pin type chain is available upon request, and can be supplied fitted with plastic pots.

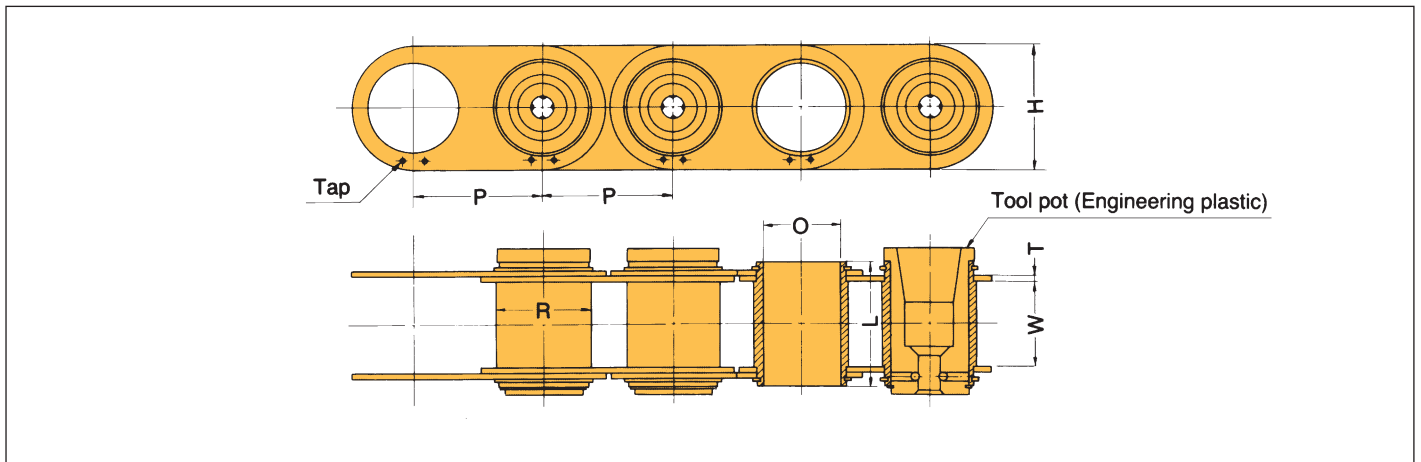

U.S. TSUBAKI									Chain Weight lbs./pot	Additional Weight/Plastic Tool Pot lbs./pot
Chain Type	Shank No.	P	O	L	H	W	R	T		
HP	40	3.543	2.165	3.406	3.465	2.362	2.677	0.157	2.6	0.6
		3.937							2.9	
	50	5.118	3.071	4.823	4.724	3.268	3.622	0.248	6.8	1.8
		5.512							7.3	
		6.299							7.7	

Note: The dimension of HP type is different from HP-T type chain. Refer to page B-89 for the key and number plate dimensions. Shanks No. 45 and 60 are also available upon request.

# U.S. TSUBAKI ATC CHAIN

## SK Type

SK Type Tool Holder chain utilizes roller chain components and specially configured side plates.  
SK Type ATC chain works with standard sprockets.

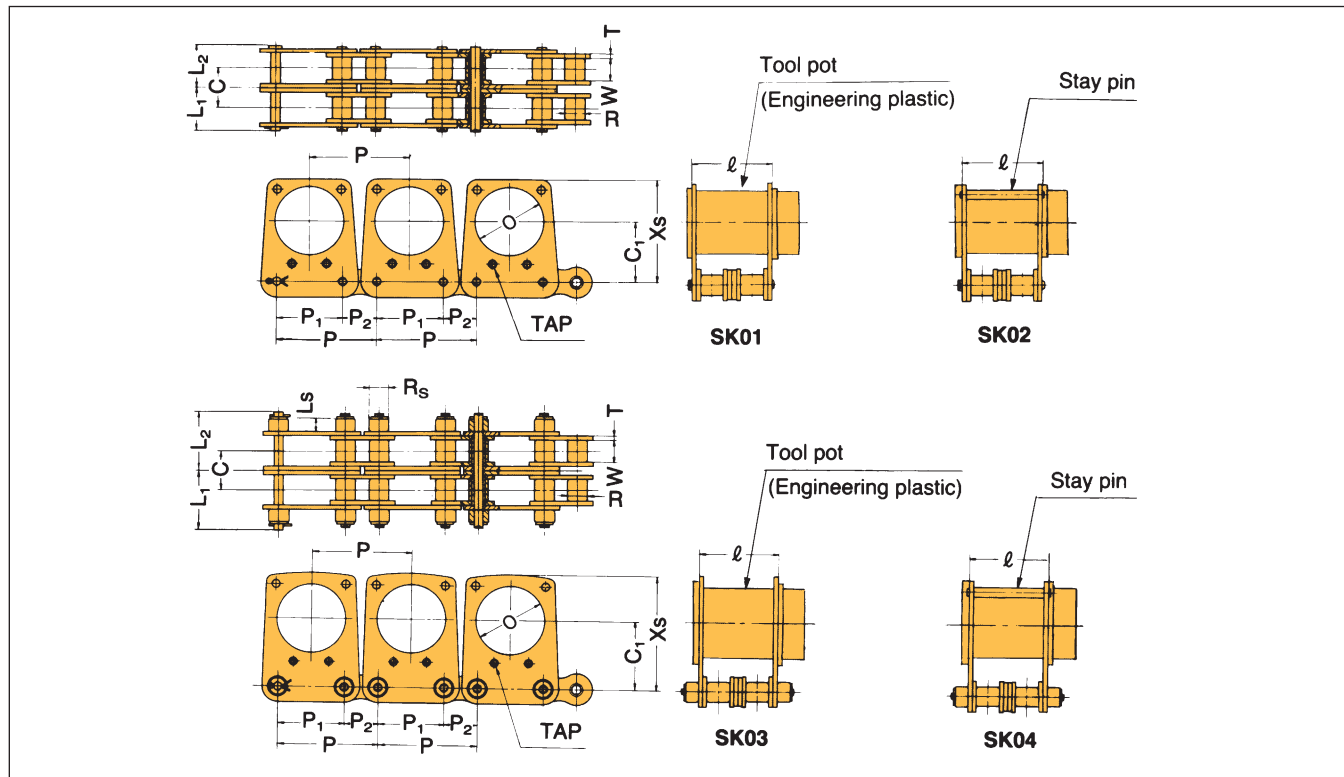

U.S. TSUBAKI Chain Type	Shank No.	P	P <sub>1</sub>	P <sub>2</sub>	O	C <sub>1</sub>	l	X <sub>s</sub>	L <sub>1</sub>	L <sub>2</sub>	C	W	R	T	R <sub>s</sub>	L <sub>s</sub>	Chain Weight lbs./pot
SK01	40	3.75	2.50	1.25	2.165	2.087	2.819	3.622	1.606	1.543	1.409	0.75	0.75	0.157	-	-	2.20
	50	4.50	3.00	1.50	3.071	2.689	3.575	4.539	2.031	1.925	1.787	1.00	0.875	0.187	-	-	3.50
		5.25	3.50	1.75		3.150	3.850	5.236	2.110	2.213	1.925		1.00	0.220	-	-	5.50
SK02	40	3.75	2.50	1.25	2.165	2.087	2.819	3.622	1.606	1.543	1.409	0.75	0.75	0.157	-	-	2.20
	50	4.50	3.00	1.50	3.071	2.689	3.575	4.539	2.031	1.925	1.787	1.00	0.275	0.189	-	-	3.70
		5.25	3.50	1.75		3.150	3.850	5.236	2.110	2.213	1.925		1.00	0.220	-	-	5.70
SK03	40	3.75	2.50	1.25	2.165	2.087	2.817	3.622	2.096	1.974	1.409	0.75	0.75	0.157	0.75	0.370	2.20
	50	4.50	3.00	1.50	3.071	3.150	3.575	5.217	2.563	2.563	1.787	1.00	0.875	0.187	0.875	0.496	3.70
		5.25	3.50	1.75			3.850	5.236	2.697	2.697	1.925		1.00	0.270			5.70
SK04	40	3.75	2.50	1.25	2.165	2.087	2.819	3.622	2.096	1.974	1.409	0.75	0.75	0.157	0.75	0.370	2.40
	50	4.50	3.00	1.50	3.071	3.150	3.575	3.217	2.563	2.563	1.787	1.00	0.875	0.189	0.875	0.496	4.00
		5.25	3.50	1.75			3.850	5.236	2.697	2.697	1.925		1.00	0.220			3.70

Note: Refer to page B-89 for the key and number plate dimensions.  
Shanks No. 45 and 60 are available upon request.

# SK-W Type

SK-W type ATC chain is a wider version of the SK type and is designed for heavier and longer tools. The added width provides increased stability.

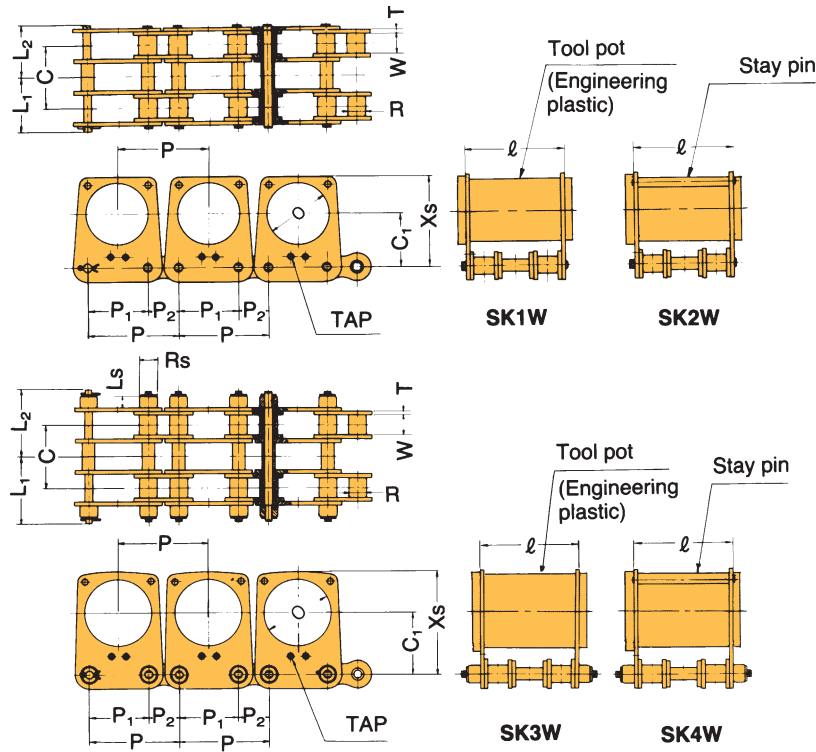

U.S. TSUBAKI																	
Chain Type	Shank No.	P	P <sub>1</sub>	P <sub>2</sub>	O	C <sub>1</sub>	ℓ	X <sub>s</sub>	L <sub>1</sub>	L <sub>2</sub>	C	W	R	T	R <sub>s</sub>	L <sub>s</sub>	Chain Weight lbs./pot
SK1W	50	4.50	3.00	1.50	3.071	2.689	4.823	4.539	2.661	2.551	3.035	1.00	0.875	0.189	–	–	3.50
		5.25	3.50	1.75		3.150		5.236	2.697	2.598	2.898		1.00	0.189	–	–	5.70
SK2W	40	3.00	2.00	1.00	2.165	2.087	3.248	3.622	1.807	1.744	2.074	0.625	0.625	0.126	–	–	1.50
		4.50	3.00	1.50		2.689		4.539	2.661	2.551	3.035	1.00	0.875	0.189	–	–	3.70
	50	5.00	2.50	2.50	3.071	3.150	4.823	5.366	7.606	2.555	3.283	0.750	0.750	0.189	–	–	2.60
SK3W	50	4.50	3.00	1.50	3.071	3.150	4.823	5.217	3.185	3.185	3.035	1.00	0.875	0.189	0.875	0.496	4.00
		5.25	3.50	1.75		3.150		5.236			2.898		1.00	0.220			5.90
	40	3.00	2.00	1.00	2.165	2.087	3.284	3.622	2.276	2.276	2.094	0.625	0.625	0.126	0.75	0.370	1.80
SK4W	50	4.50	3.00	1.50	3.071	3.150	4.823	5.217	3.185	3.185	3.035	1.00	0.875	0.189	0.875	0.496	4.20
		5.00	2.50	2.50				5.366			3.283		0.750	0.750			0.189
	50	5.75	3.50	1.75	5.236	2.890	1.00	1.00	0.220	5.90							

Note: Refer to page B-89 for the key and number plate dimensions.  
Shanks No. 45 and 60 are available upon request. Consult U.S. Tsubaki.