

# Shaft, Key and Flange Dimensions (in.)

## Shaft Tolerance

Nominal Shaft Dia.	Tolerance
1/4 ~ 1 1/2	+0 ~ -.0005"
+1 1/2 ~ 6 1/2	+0 ~ -.001"

## Parallel Key and Keyseats (ANSI B 17.1-1967, R1973)

Shaft diameter and accompanying key size

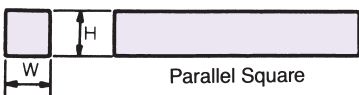

Nominal Shaft Diameter		Nominal Key Size		Nominal Keyseat Depth
Over	To (incl.)	Width W	Height H	H/2
5/16	7/16	3/32	3/32	3/64
7/16	9/16	1/8	1/8	1/16
9/16	7/8	3/16	3/16	3/32
7/8	1 1/4	1/4	1/4	1/8
1 1/4	1 3/8	5/16	5/16	5/32
1 3/8	1 3/4	3/8	3/8	3/16
1 3/4	2 1/4	1/2	1/2	1/4
2 1/4	2 3/4	5/8	5/8	5/16
2 3/4	3	3/4	3/4	3/8

## ANSI Standard Fits for Parallel Keys

Type of Key	Key Width		Side Fit		
	Over	To (incl.)	Width Tolerance		Fit Range
			Key	Keyseat	
Parallel Square	—	3/4	+0.001 -0.000	+0.002 -0.000	0.002 CL 0.001 INT

CL = Clearance INT = Interference

## Depth Control Values S and T for Shaft and Hub

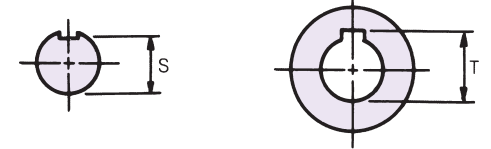

Nominal Shaft Diameter	Parallel Square		Nominal Shaft Diameter	Parallel Square	
	S	T		S	T
1/2	.430	.560	1 13/16	1.527	2.032
9/16	.493	.623	1 7/8	1.591	2.096
5/8	.517	.709	1 15/16	1.655	2.160
11/16	.581	.773	2	1.718	2.223
3/4	.644	.837	2 1/16	1.782	2.287
13/16	.708	.900	2 1/8	1.845	2.350
7/8	.771	.964	2 3/16	1.909	2.414
15/16	.796	1.051	2 1/4	1.972	2.477
1	.859	1.114	2 5/16	1.957	2.587
1 1/16	.923	1.178	2 3/8	2.021	2.651
1 1/8	.986	1.241	2 7/16	2.084	2.714
1 3/16	1.049	1.304	2 1/2	2.148	2.778
1 1/4	1.112	1.367	2 9/16	2.211	2.841
1 5/16	1.137	1.455	2 5/8	2.275	2.905
1 3/8	1.201	1.518	2 11/16	2.338	2.968
1 7/16	1.255	1.605	2 3/4	2.402	3.032
1 1/2	1.289	1.669	2 13/16	2.387	3.142
1 9/16	1.352	1.732	2 7/8	2.450	3.205
1 5/8	1.416	1.796	2 15/16	2.514	3.269
1 11/16	1.479	1.859	3	2.577	3.332
1 3/4	1.542	1.922			

## Details of NEMA-C Flange Input Type

NEMA Frame No.	B	D	J	K	T	U	V	W	Y	Hole dia.		
56C	.236	6.63	5.875	4.500	+0.0014 -.0	.55	5/8	+0.0015 -.0	.709	.1875	2.100	.433
143/145 TC	.236	6.50	5.875	4.500	+0.0014 -.0	.55	7/8	+0.0020 -.0	.964	.1875	2.200	.433
182/184 TC	.236	9.00	7.250	8.500	+0.0018 -.0	.944	1 1/8	+0.0020 -.0	1.241	.25	2.866	1.591
213/215 TC	.236	9.00	7.250	8.500	+0.0018 -.0	.78	1 3/8	+0.0020 -.0	1.518	.3125	3.361	1.591

Dimension Y is for quill shaft depth of DISCO.

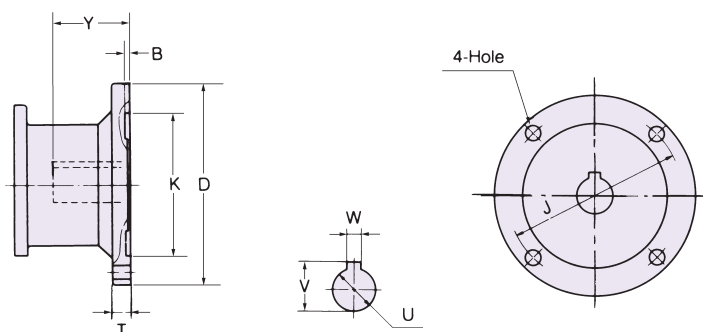

For DK002 up to DK015

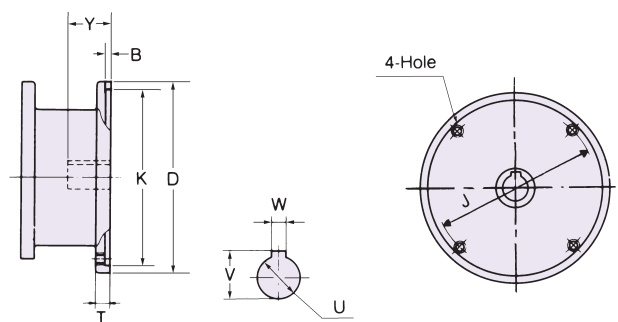

For DK022 up to DK075