

Hypoid Motor TA Series Outline Dimensions

Inline reducer type

HYPOID MOTOR TA Outline Dimensions

24 0.1kW HRTA010-19L5~50 $\frac{L}{T}$

Reduction ratio : 5, 10, 15, 20, 25, 30, 40, 50

Approx. weight : 3.5kg

Reference page : Specification Chart→P211

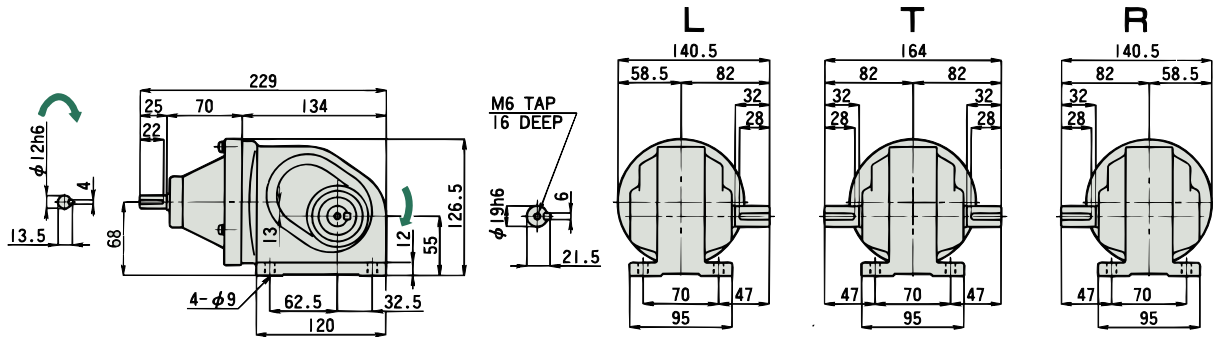

25 0.1kW HRTA010-24L60~200 $\frac{L}{T}$

1/60 \curvearrowright 、1/80~1/200 \curvearrowright

Reduction ratio : 60, 80, 100, 120, 160, 200

Approx. weight : 9.0kg

Reference page : Specification Chart→P211

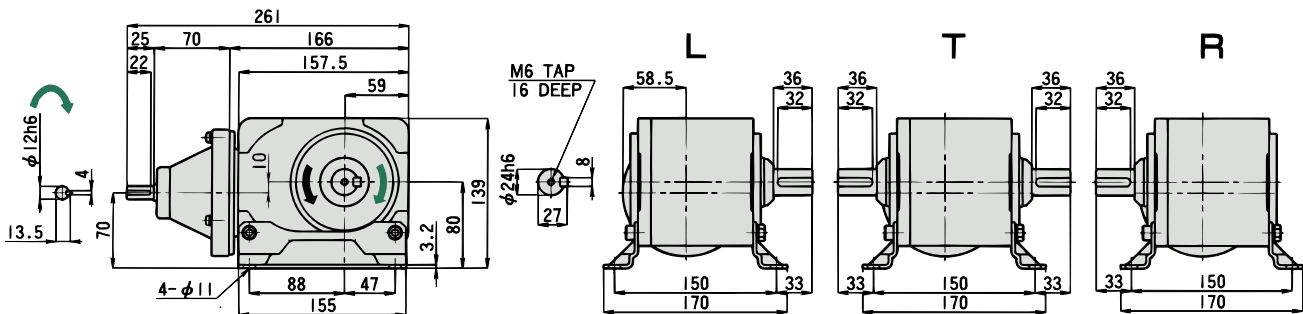

26 0.1kW HRTA010-24U5~200 $\frac{S}{T}$

1/5~1/60 \curvearrowright 、1/80~1/200 \curvearrowright

Reduction ratio : 5, 10, 15, 20, 25, 30, 40, 50, 60, 80, 100, 120, 160, 200

Approx. weight : 8.0kg

Reference page : Specification Chart→P211

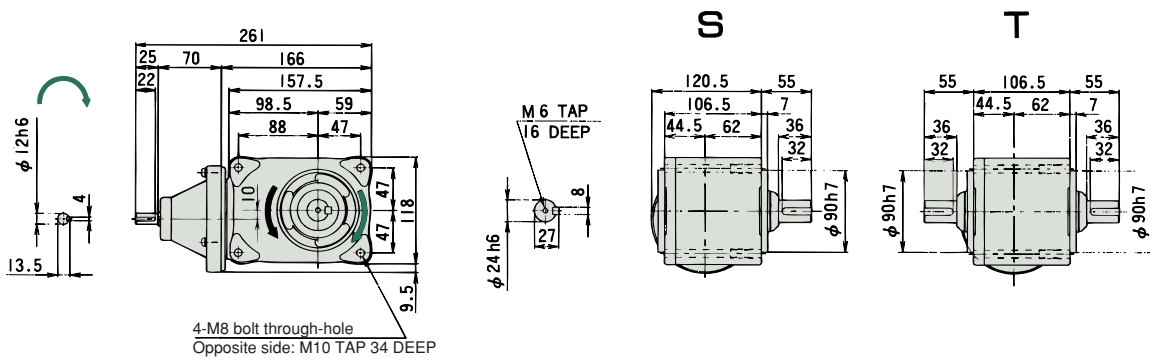

4-M8 bolt through-hole
Opposite side: M10 TAP 34 DEEP

27 0.1kW HRTA010-30H5~200

1/5~1/60 \curvearrowright 、1/80~1/200 \curvearrowright

Reduction ratio : 5, 10, 15, 20, 25, 30, 40, 50, 60, 80, 100, 120, 160, 200

Approx. weight : 7.0kg

Reference page : Specification Chart→P211 Options→P184

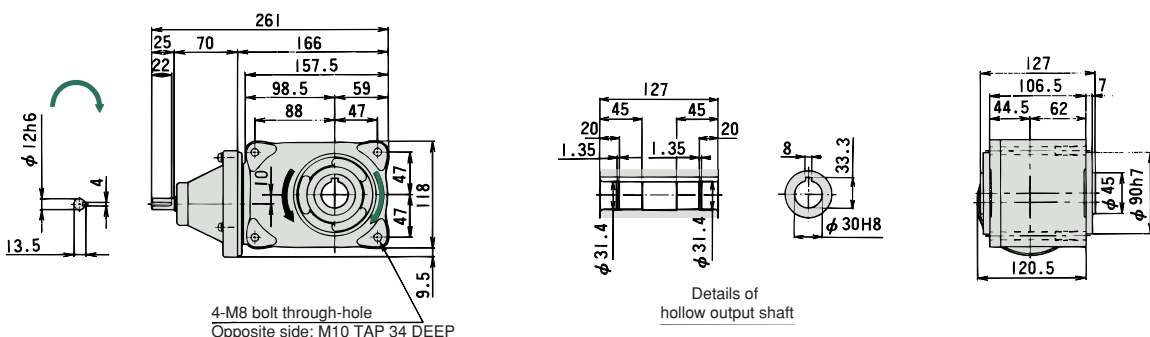

4-M8 bolt through-hole
Opposite side: M10 TAP 34 DEEP

Details of hollow output shaft

Hypoid Motor TA Series Outline Dimensions

Inline reducer type

HYPOID MOTOR TA Outline Dimensions

28 0.2kW HRTA020-19L5~50 $\frac{L}{R}$

Reduction ratio : 5, 10, 15, 20, 25, 30, 40, 50

Approx. weight : 3.5kg

Reference page : Specification Chart→P211

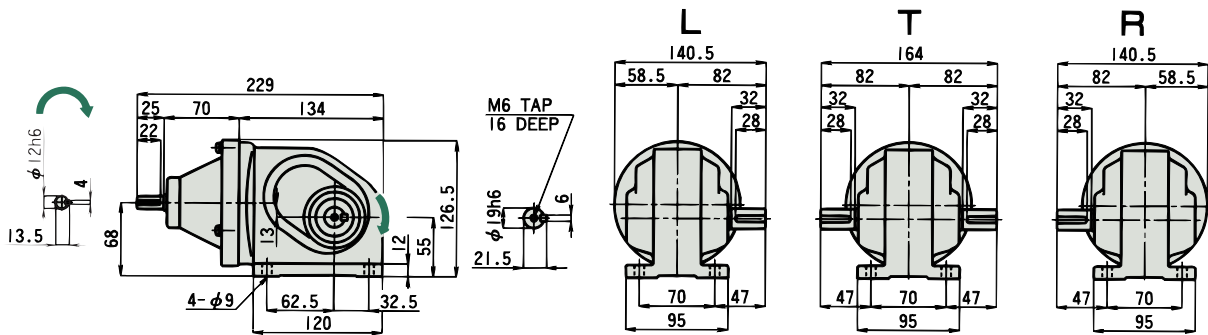

29 0.2kW HRTA020-28L60~200 $\frac{L}{R}$

1/60 \curvearrowright 、1/80~1/200 \curvearrowright

Reduction ratio : 60, 80, 100, 120, 160, 200

Approx. weight : 9.0kg

Reference page : Specification Chart→P211

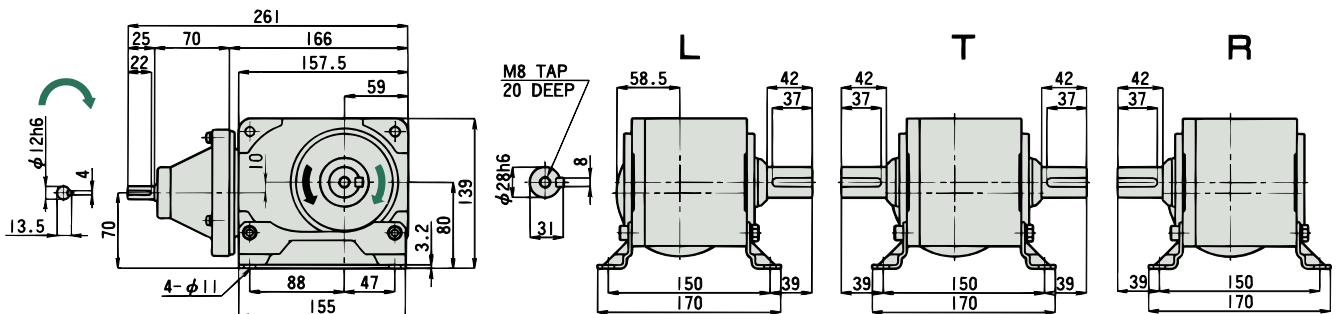

30 0.2kW HRTA020-28U5~200 $\frac{S}{T}$

1/5~1/60 \curvearrowright 、1/80~1/200 \curvearrowright

Reduction ratio : 5, 10, 15, 20, 25, 30, 40, 50, 60, 80, 100, 120, 160, 200

Approx. weight : 8.0kg

Reference page : Specification Chart→P211

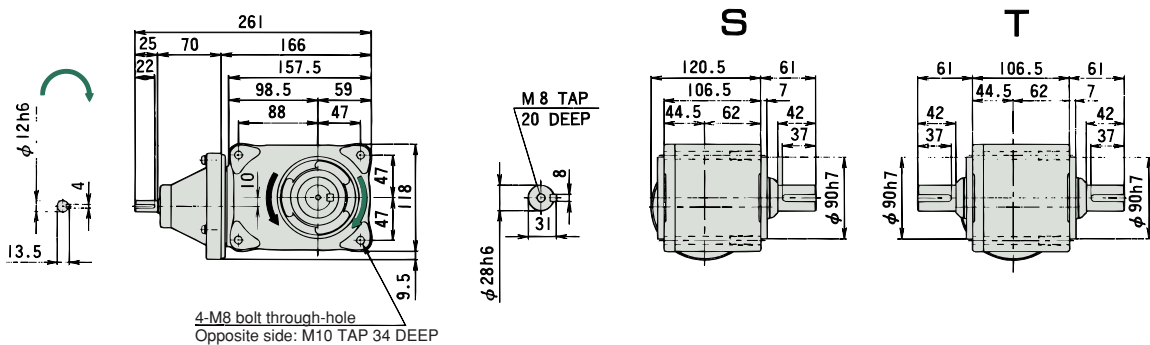

31 0.2kW HRTA020-30H5~200

1/5~1/60 \curvearrowright 、1/80~1/200 \curvearrowright

Reduction ratio : 5, 10, 15, 20, 25, 30, 40, 50, 60, 80, 100, 120, 160, 200

Approx. weight : 7.0kg

Reference page : Specification Chart→P211 Options→P184

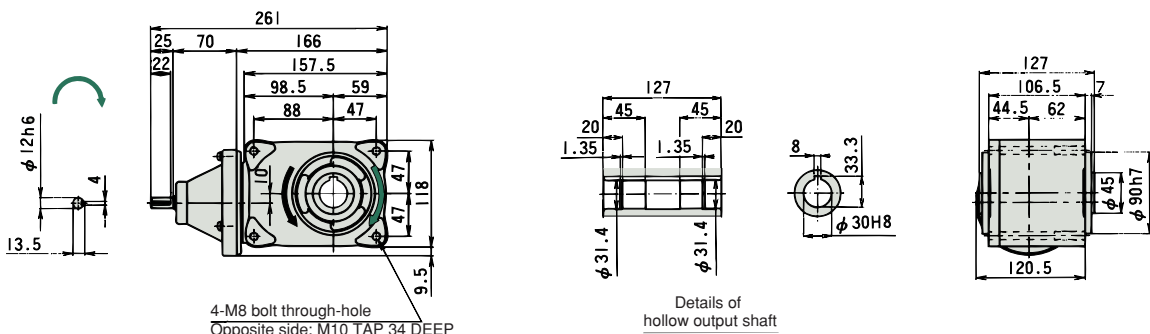

Note) For "T" output shaft arrangements, the phases of the key ways of the output shafts are not necessarily aligned precisely.

Outline Dimensions

L.U.H

28

29

30

31

0.2

Hypoid Motor TA Series Outline Dimensions

Inline reducer type

HYPOID MOTOR TA Outline Dimensions

32 0.4kW HRTA040-24L5~50 ^L/_T/_R

Reduction ratio : 5, 10, 15, 20, 25, 30, 40, 50

Approx. weight : 6.0kg

Reference page : Specification Chart→P211

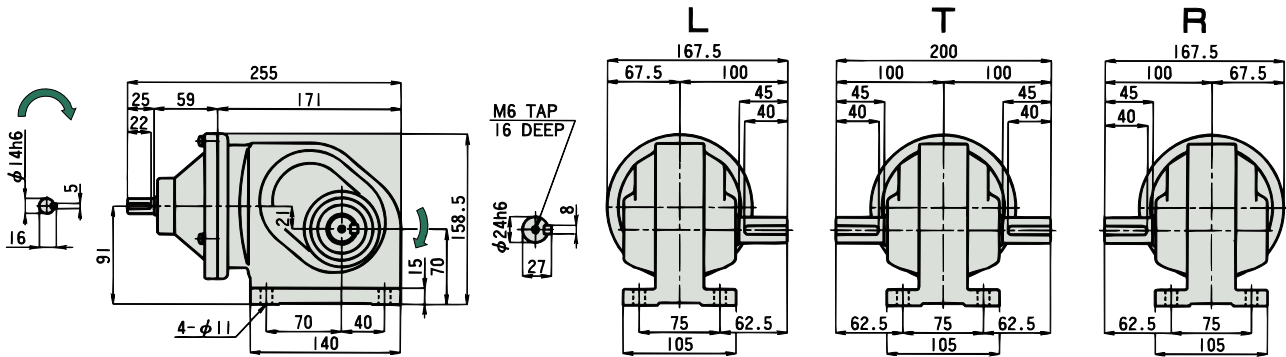

33 0.4kW HRTA040-38L60~200 ^L/_T/_R

Reduction ratio : 60, 80, 100, 120, 160, 200

Approx. weight : 14.5kg

Reference page : Specification Chart→P211

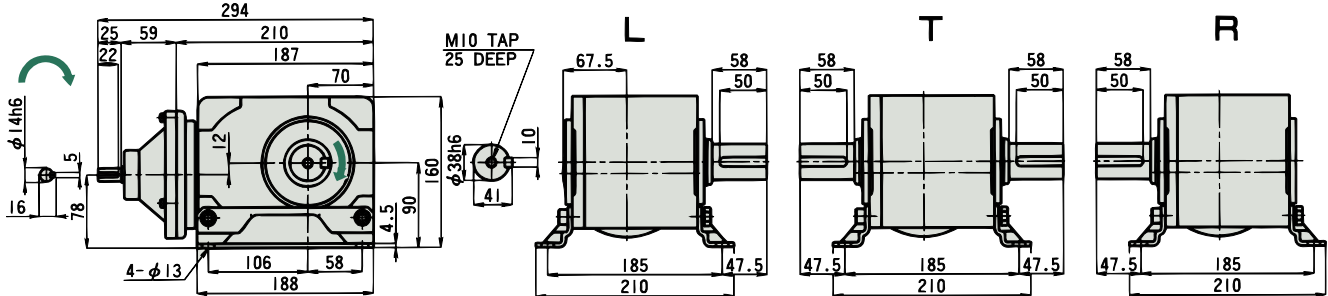

34 0.4kW HRTA040-28U5~50 ^S/_T

1/5~1/30 \curvearrowright , 1/40~1/50 \curvearrowright

Reduction ratio : 5, 10, 15, 20, 25, 30, 40, 50

Approx. weight : 9.0kg

Reference page : Specification Chart→P211

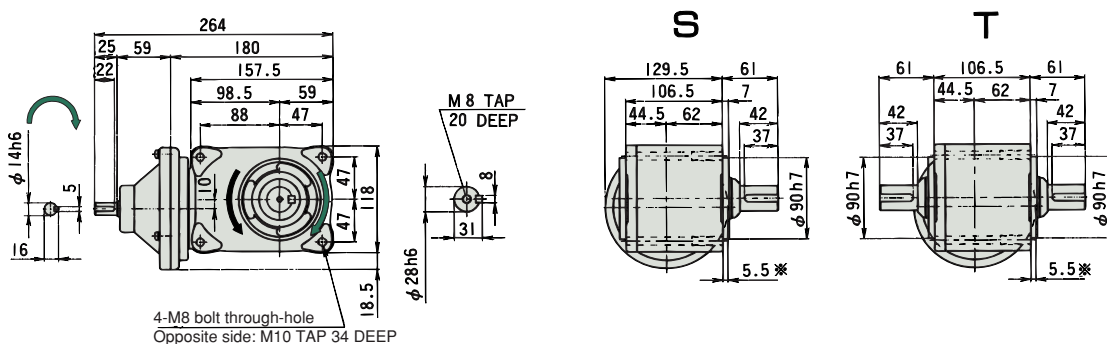

4-M8 bolt through-hole
Opposite side: M10 TAP 34 DEEP

35 0.4kW HRTA040-38U60~200 ^S/_T

Reduction ratio : 60, 80, 100, 120, 160, 200

Approx. weight : 13.5kg

Reference page : Specification Chart→P211

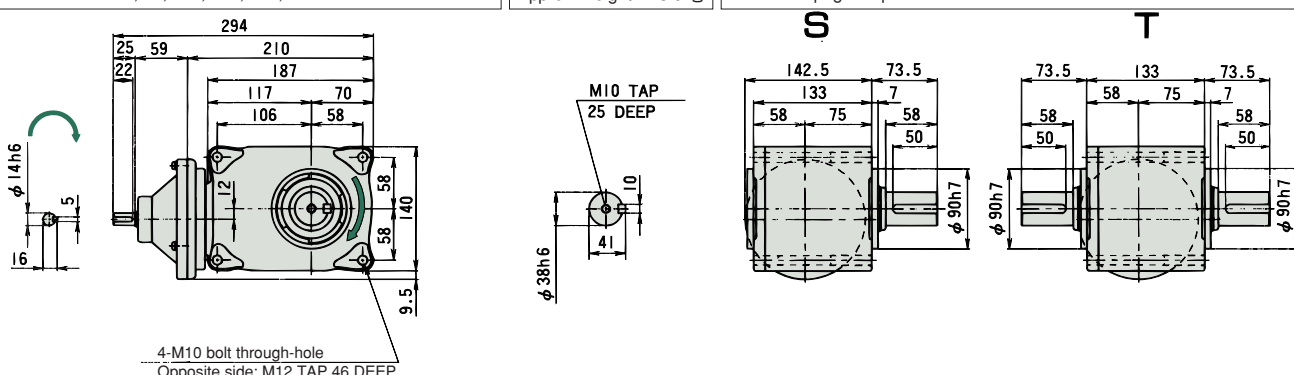

4-M10 bolt through-hole
Opposite side: M12 TAP 46 DEEP

Hypoid Motor TA Series Outline Dimensions

Inline reducer type

HYPOID MOTOR TA Outline Dimensions

36 0.4kW HRTA040-30H5~50

1/5~1/30 (、 1/40~1/50)

Reduction ratio : 5, 10, 15, 20, 25, 30, 40, 50

Approx. weight : 8.0kg

Reference page : Specification Chart→P211 Options→P184

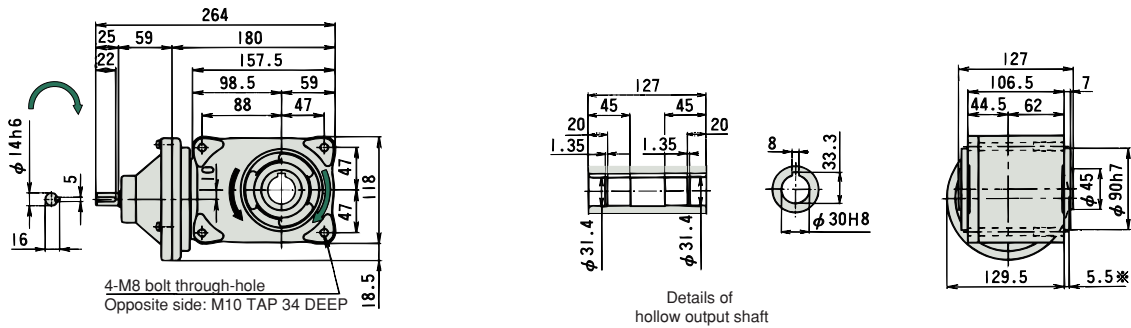

37 0.4kW HRTA040-35H60~200

Reduction ratio : 60, 80, 100, 120, 160, 200

Approx. weight : 12.0kg

Reference page : Specification Chart→P211 Options→P184

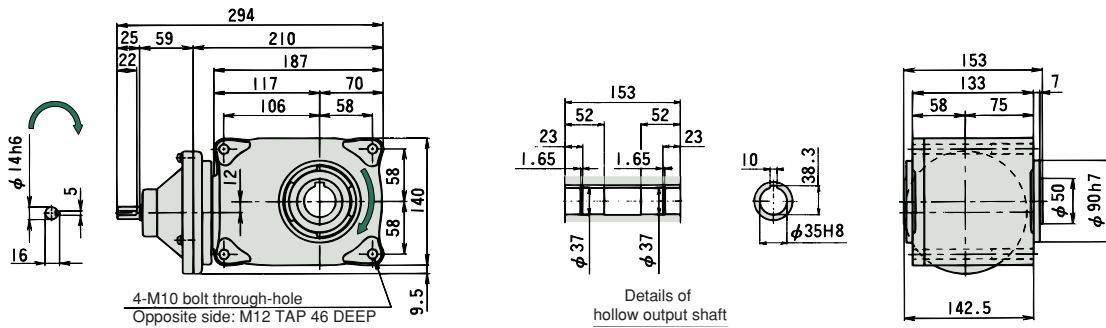

Note) The dimension marked with * indicates that part of the input shaft bracket protrudes from the mounting surface.

Hypoid Motor TA Series Outline Dimensions

Inline reducer type

HYPOID MOTOR TA Outline Dimensions

38 0.75kW HRTA075-30L5~50^L_T_R

Reduction ratio : 5, 10, 15, 20, 25, 30, 40, 50

Approx. weight : 9.0kg

Reference page : Specification Chart→P212

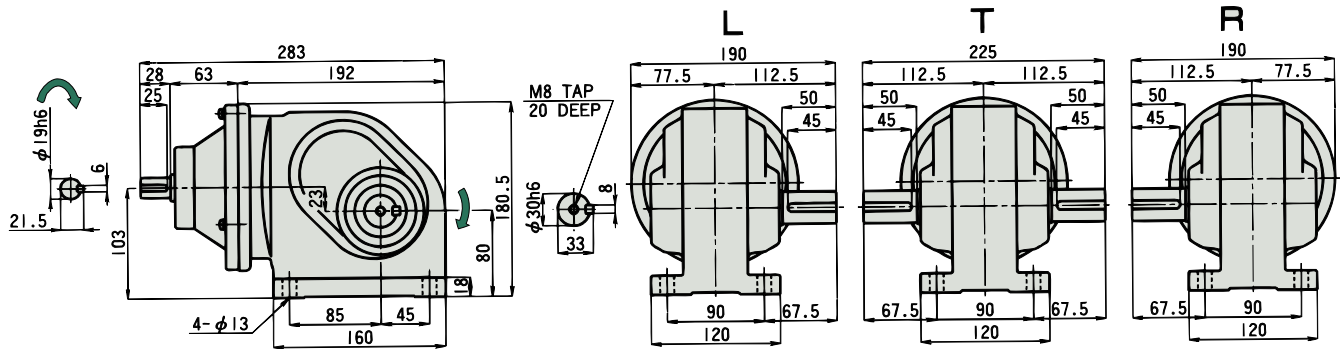

39 0.75kW HRTA075-42L60~200^L_T_R

Reduction ratio : 60, 80, 100, 120, 160, 200

Approx. weight : 26.0kg

Reference page : Specification Chart→P212

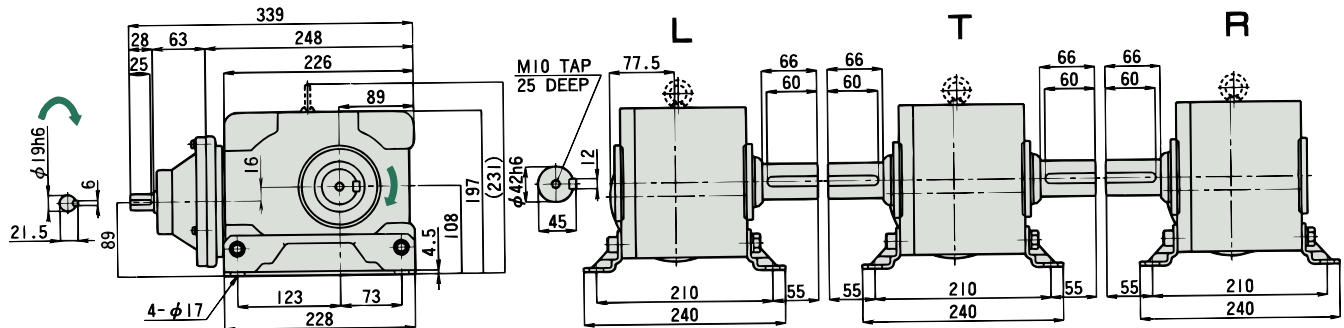

40 0.75kW HRTA075-38U5~50^S

1/5~1/30 (S), 1/40~1/50 (T)

Reduction ratio : 5, 10, 15, 20, 25, 30, 40, 50

Approx. weight : 13.5kg

Reference page : Specification Chart→P212

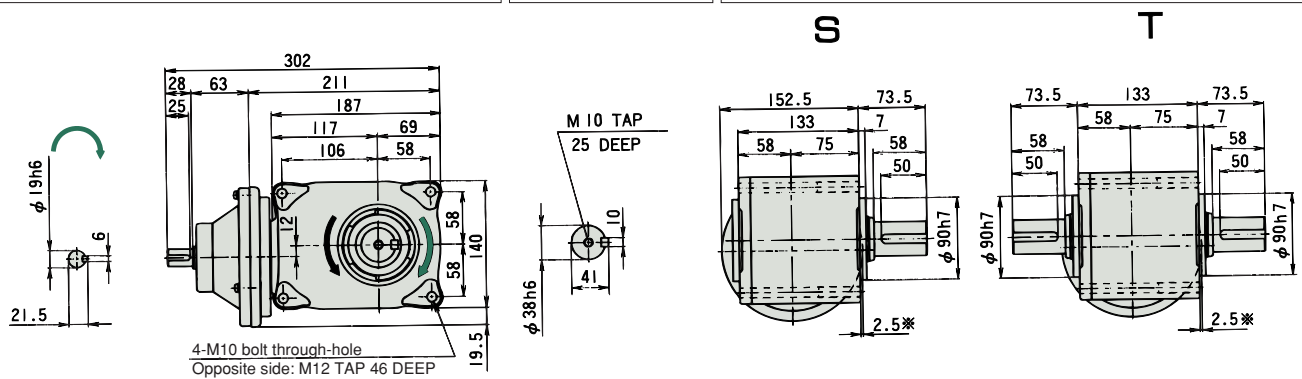

4-M10 bolt through-hole
Opposite side: M12 TAP 46 DEEP

41 0.75kW HRTA075-42U60~200^S

Reduction ratio : 60, 80, 100, 120, 160, 200

Approx. weight : 24.5kg

Reference page : Specification Chart→P212

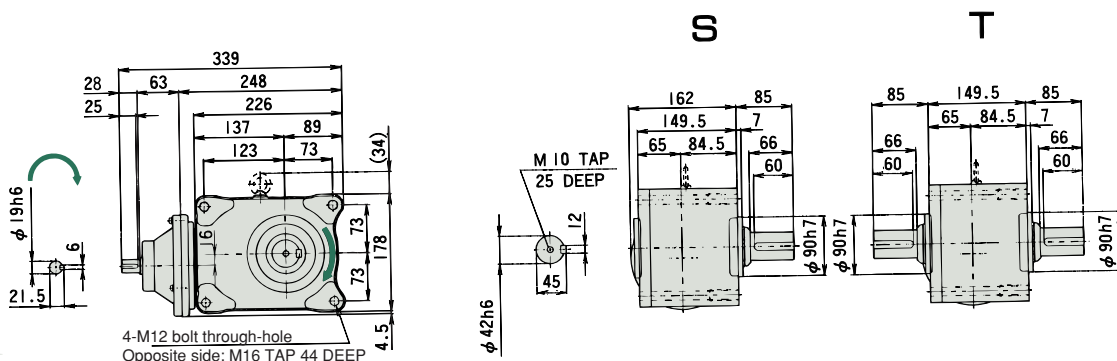

4-M12 bolt through-hole
Opposite side: M16 TAP 44 DEEP

Hypoid Motor TA Series Outline Dimensions

Inline reducer type

HYPOID MOTOR TA Outline Dimensions

42 0.75kW HRTA075-35H5~50

1/5~1/30 ↺、1/40~1/50 ↻

Reduction ratio : 5, 10, 15, 20, 25, 30, 40, 50

Approx. weight : 12.0kg

Reference page : Specification Chart→P212 Options→P184

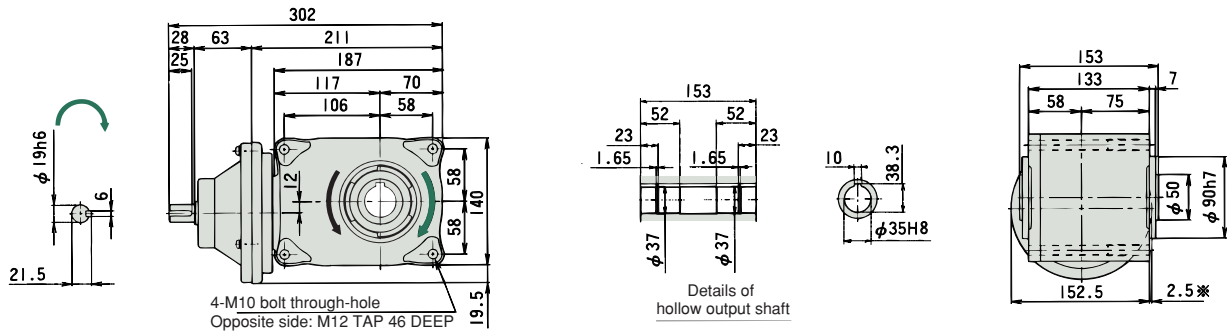

43 0.75kW HRTA075-45H60~200

Reduction ratio : 60, 80, 100, 120, 160, 200

Approx. weight : 20.5kg

Reference page : Specification Chart→P212 Options→P184

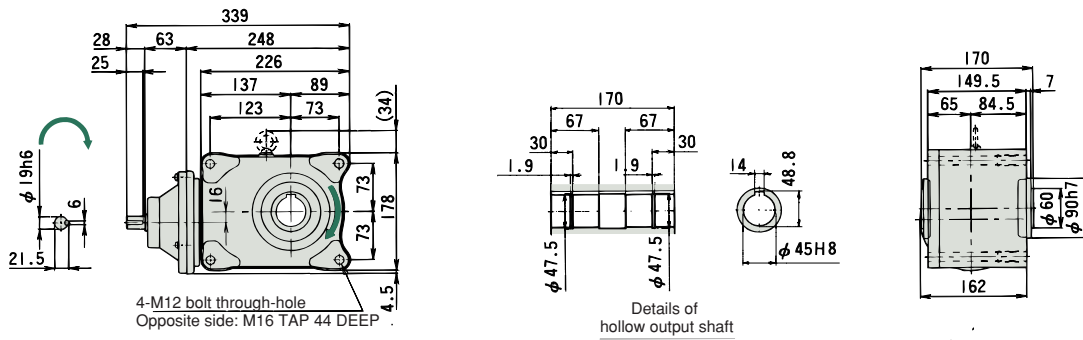

Note) The dimension marked with ※ indicates that part of the input shaft bracket protrudes from the mounting surface.

Hypoid Motor TA Series Outline Dimensions

Inline reducer type

HYPOID MOTOR TA Outline Dimensions

44 1.5kW HRTA150-42L5~50^L_T

1/5~1/30 ↺, 1/40~1/50 ↻

Reduction ratio : 5, 10, 15, 20, 25, 30, 40, 50

Approx. weight : 39.0kg

Reference page : Specification Chart→P212

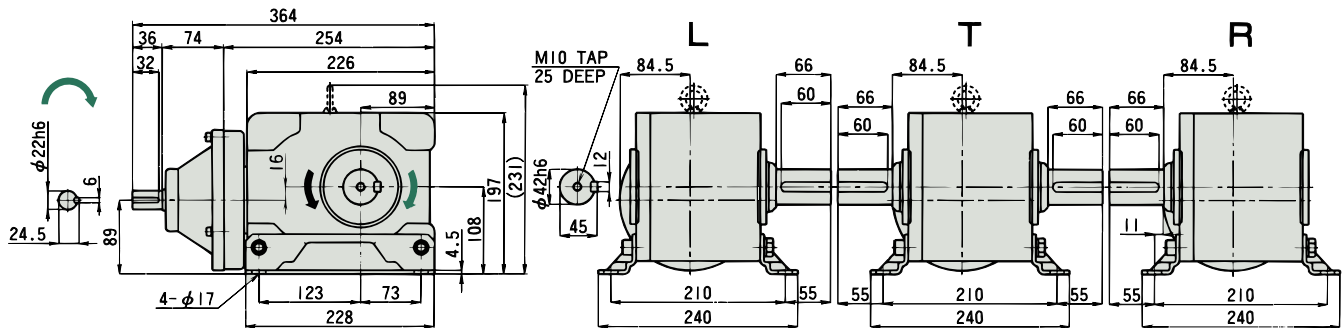

45 1.5kW HRTA150-42U5~50^S

1/5~1/30 ↺, 1/40~1/50 ↻

Reduction ratio : 5, 10, 15, 20, 25, 30, 40, 50

Approx. weight : 26.0kg

Reference page : Specification Chart→P212

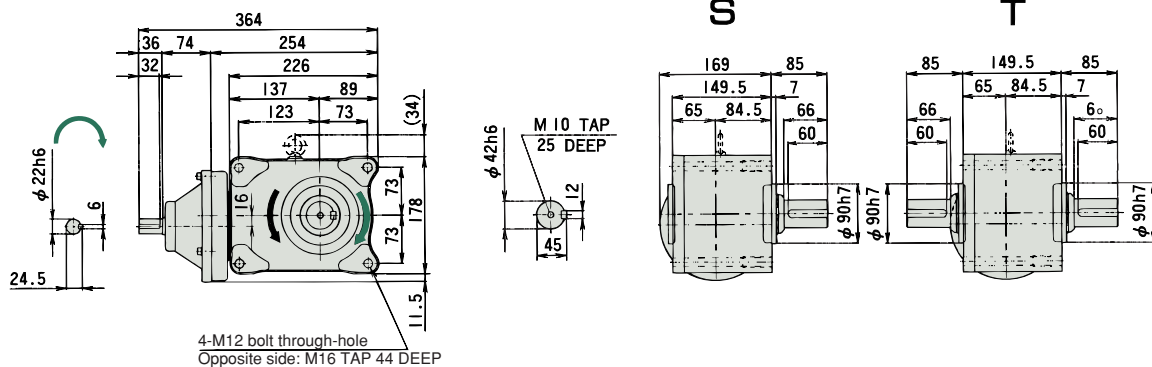

46 1.5kW HRTA150-45H5~50

1/5~1/30 ↺, 1/40~1/50 ↻

Reduction ratio : 5, 10, 15, 20, 25, 30, 40, 50

Approx. weight : 22.0kg

Reference page : Specification Chart→P212 Options→P184

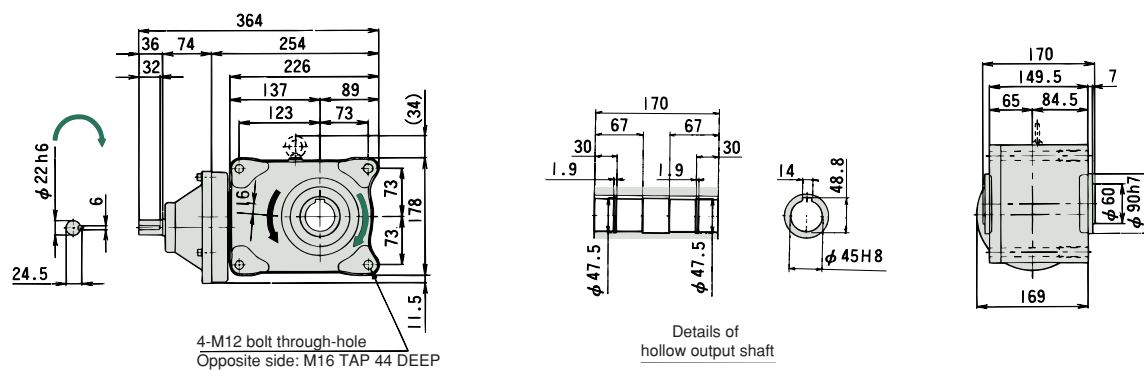

Note) The phases of the key ways of the output shaft and input shafts are not necessarily aligned precisely. For "T" output shaft arrangements, the phases of the key ways of the output shafts are not necessarily aligned precisely.

Outline Dimensions

L.U.H
44
45
46
1.5