

Best suited for high-frequency operation— A rank above others

- Compact, lightweight and low-noise TA series reducer
- Easy-to-use long-life clutch/brake types

■ Features

C

OMPACT

The clutch/brake is directly connected between the motor and the reducer as an assembly and requires only a small installation space. In addition, the time for installation and centering is reduced compared to combining units.

B

ALANCE

The torque of the clutch/brake is optimally adjusted in consideration of the motor capacity and load conditions. The clutch/brake and reducer operate in balance offering greater durability.

G

RADE UP

Because of the unique design of the clutch/brake and the reducer housing construction, heat is quickly dissipated, which enables frequent on-off switching. Because the TA series has a reputation for low noise and durability, high reliability is ensured. A wide range of types are available (0.1 kW-3.7 kW, reduction ratios of 1/5-1/200), providing a perfect match for any application.

M

AINTEANCE EASY

The clutch/brake includes an automatic gap control system that eliminates the need for performing troublesome gap adjustment as the friction plate wears, ensuring reliable operation for a long time. Since the reducer uses an enclosed grease bath and changing grease is often not necessary, maintenance is not necessary for a long time.

■ Structure

■ GMTA040-24L25CB

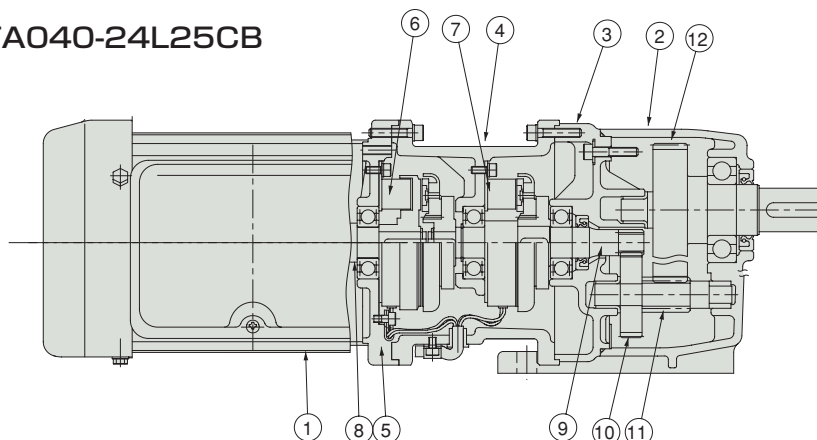

- 1 . Motor
- 2 . L case
- 3 . M bracket
- 4 . Housing
- 5 . Motor flange
- 6 . Clutch
- 7 . Brake
- 8 . Motor shaft
- 9 . Input shaft with pinion
- 10 . 1st stage wheel
- 11 . 2nd shaft with pinion
- 12 . Output shaft with wheel

Operating principle

1. Stopping

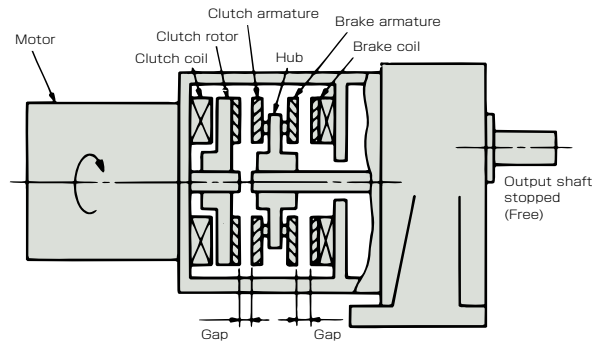

Motor: ON or OFF
Clutch: OFF
Brake: OFF

2. Clutching

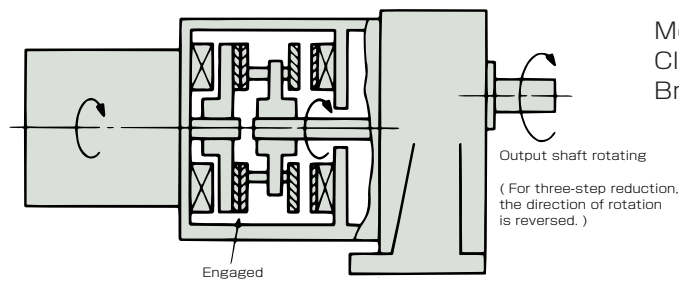

Motor: ON
Clutch: ON
Brake: OFF

3. Braking

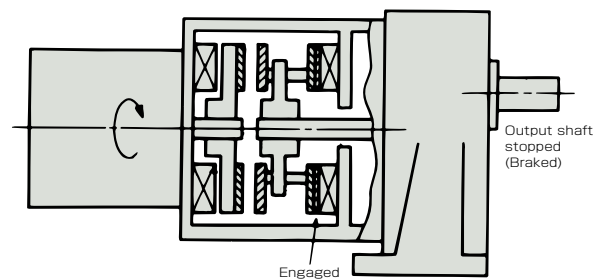

Motor: ON
Clutch: OFF
Brake: ON

