

# SEALED WELDED STEEL CHAIN

Most chain wear and elongation is the result of abrasion wear on the pins. Tsubaki's unique patent pending design helps keep abrasive debris from entering the critical pin-bushing area, ultimately extending the life of the chain.

## Features Include:

- Made in U.S.A.
- Precision die stamped sidebars
- Machine controlled welded barrels
- Through-hardened barrels and sidebars
- High quality induction hardened alloy steel pins
- Replacement for standard chain

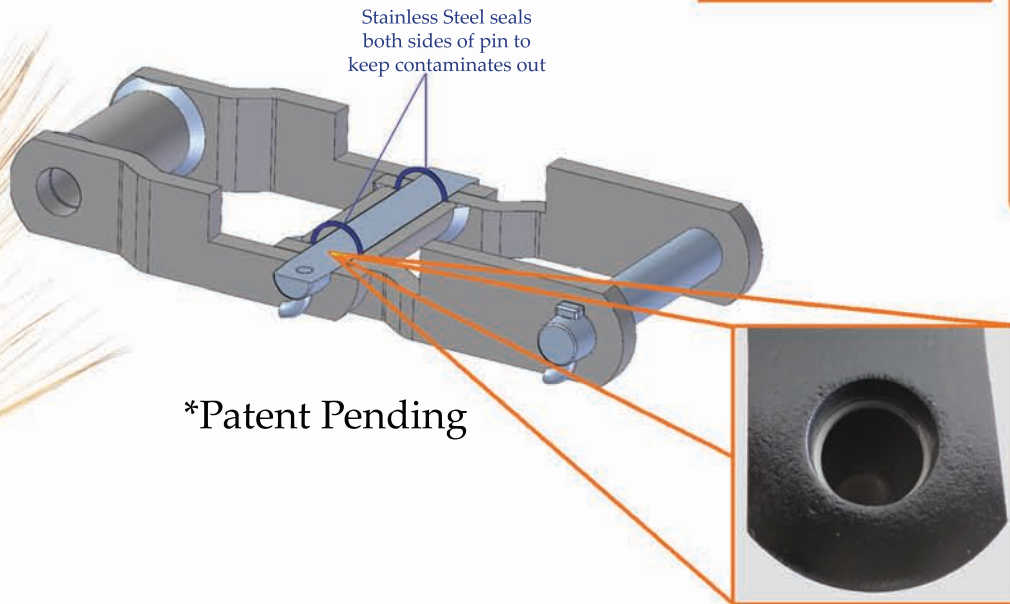

## Also available with these premium features for even greater wear life:

- 300 Series Stainless Steel for excellent corrosion resistance
- 400 Series & Precipitation Hardened Stainless Steel for high strength and corrosion resistance
- Hard chrome plated pins for extra abrasion resistance
- Lube ported pins so the chain can be lubricated from within
- Pre-greased in the factory for smooth "break in"



# SEALED WELDED STEEL CHAIN

**Offset Sidebar**

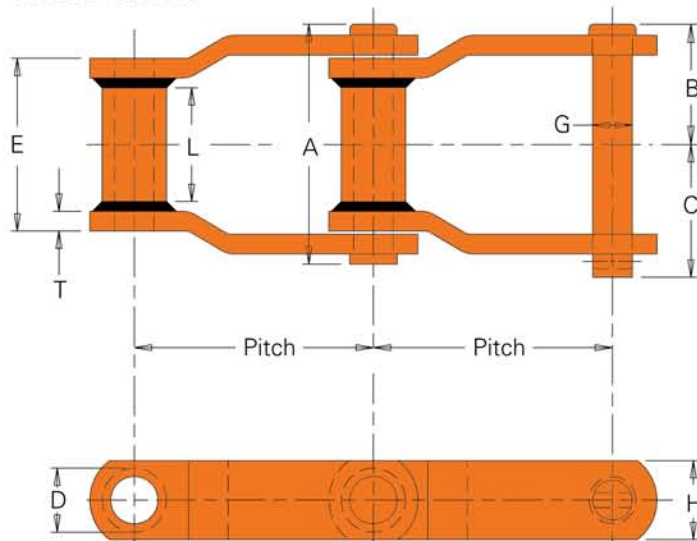

**WCH-Style Chain**

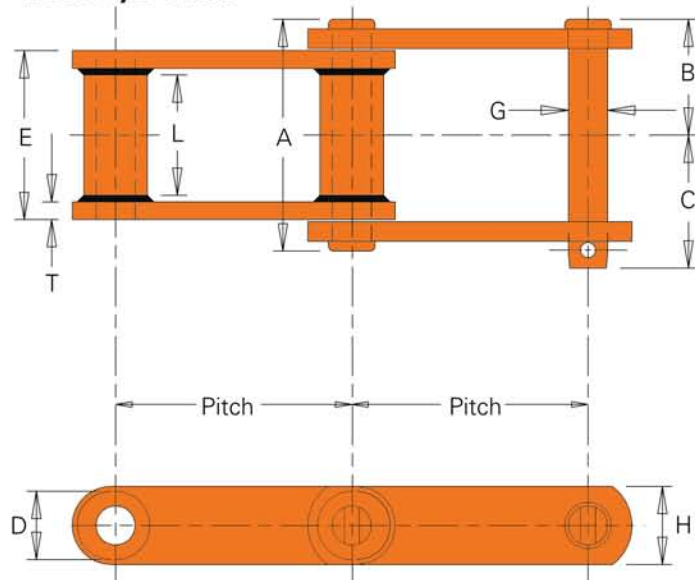

## Welded Steel Chain Specifications

Chain No.	Pitch	Chain Width				Barrel		Pin	Sidebars		Avg Ult. Strength (lbs.)	Max. Work Load (lbs.)	Approx. Weight (lbs./ft)
		Overall	Pin Head to CL	Pin End to CL	Length of Bearing				Thick	Height			
		A	B	C	E	D	L	G	T	H			
WH-124SJ1	4.000	4.25	2.03	2.22	2.75	1.25	1.63	.75	.38	1.50	60,000	7,350	8.3
WH-124HSJ1	4.063	4.75	2.28	2.47	3.00	1.75	1.63	1.00	.50	2.00	100,000	10,500	14.7
WH-111SJ1	4.760	4.88	2.34	2.54	3.38	1.38	2.38	.75	.38	1.75	60,000	8,850	9.5
WH-106SJ1	6.000	4.25	2.03	2.31	2.75	1.25	1.63	.75	.38	1.50	60,000	7,200	7.0
WH-132SJ1	6.050	6.25	3.00	3.40	4.38	1.75	2.88	1.00	.50	2.00	100,000	15,300	14.2
WH-150SJ1	6.050	6.25	3.00	3.25	4.38	1.75	2.88	1.00	.50	2.50	100,000	15,300	16.8
WH-155SJ1	6.050	6.91	3.25	3.66	4.63	1.75	3.00	1.13	.63	2.50	184,000	20,000	20.0
WCH-132SJ1	6.050	6.25	3.00	3.25	4.38	1.75	2.88	1.00	.50	2.00	100,000	15,300	14.2